

SST2S-- 90° Weld Bio-Pharm Elbow (ASME-BPE)			
Tube OD (Size)	A	Nominal Wall	Part Number
1/2"	3.000	0.065	316L SST2S-0.50-316L
3/4"	3.000	0.065	SST2S-0.75-316L
1"	3.000	0.065	SST2S-1-316L
1.5"	3.750	0.065	SST2S-1.5-316L
2"	4.750	0.065	SST2S-2-316L
2.5"	5.500	0.065	SST2S-2.5-316L
3"	6.250	0.065	SST2S-3-316L
4"	8.000	0.083	SST2S-4-316L

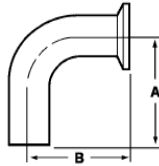

SST2CM-- Clamp x Weld 90° Elbow			
Tube OD (Size)	A	B	Part Number
1/2"	3.000	3.500	316L SST2CM-0.50-316L
3/4"	3.000	3.500	SST2CM-0.75-316L
1"	3.000	3.500	SST2CM-1-316L
1.5"	3.750	4.250	SST2CM-1.5-316L
2"	4.750	5.250	SST2CM-2-316L
2.5"	5.500	6.000	SST2CM-2.5-316L
3"	6.250	6.750	SST2CM-3-316L
4"	8.000	8.625	SST2CM-4-316L

Note:
Not to
BPE
Dimension

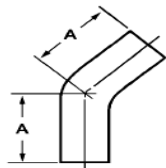

SST2KS-- 45° Weld Bio-Pharm Elbow (ASME-BPE)			
Tube OD (Size)	A	Nominal Wall	Part Number
1/2"	2.250	0.065	316L SST2KS-0.50-316L
3/4"	2.250	0.065	SST2KS-0.75-316L
1"	2.250	0.065	SST2KS-1-316L
1.5"	2.500	0.065	SST2KS-1.5-316L
2"	3.000	0.065	SST2KS-2-316L
2.5"	3.375	0.065	SST2KS-2.5-316L
3"	3.625	0.065	SST2KS-3-316L
4"	4.500	0.083	SST2KS-4-316L

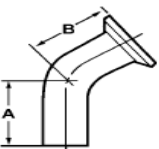

SST2KM-- Clamp x 45° Weld Elbow			
Tube OD (Size)	A	B	Part Number
1/2"	2.250	2.750	316L SST2KM-0.50-316L
3/4"	2.250	2.750	SST2KM-0.75-316L
1"	2.250	2.750	SST2KM-1-316L
1.5"	2.500	3.000	SST2KM-1.5-316L
2"	3.000	3.500	SST2KM-2-316L
2.5"	3.375	3.875	SST2KM-2.5-316L
3"	3.625	4.125	SST2KM-3-316L
4"	4.500	5.125	SST2KM-4-316L

Note:
Not to
BPE
Dimension

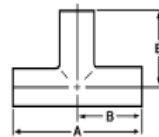

SST7WWW--- Weld Bio-Pharm Tee (ASME-BPE)			
Tube OD (Size)	A	B	Part Number
1/2"	3.750	1.875	316L SST7WWW-0.50-316L
3/4"	4.000	2.000	SST7WWW-0.75-316L
1"	4.250	2.125	SST7WWW-1-316L
1.5"	4.750	2.375	SST7WWW-1.5-316L
2"	5.750	2.875	SST7WWW-2-316L
2.5"	6.250	3.125	SST7WWW-2.5-316L
3"	6.750	3.375	SST7WWW-3-316L
4"	8.250	4.125	SST7WWW-4-316L

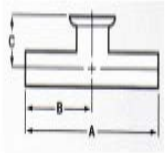

SST7-54WWC-- Instrument Tee-- Butt weld on Each End x SHORT Clamp on Branch (ASME-BPE)				
Tube OD (Size)	A	B	C	Part Number
1/2" x 3/4"	5.250	2.625	0.875	316L SST7-54WWC-0.50 x 0.75-316L
1/2" x 1"	5.500	2.750	0.875	316L SST7-54WWC-0.50 x 1-316L
1/2" x 1.5"	6.000	3.000	0.875	316L SST7-54WWC-0.50 x 1.5-316L
1/2" x 2"	6.500	3.250	1.000	316L SST7-54WWC-0.50 x 2-316L
3/4" x 1"	5.500	2.750	1.000	316L SST7-54WWC-0.75 x 1-316L
3/4" x 1.5"	6.000	3.000	1.000	316L SST7-54WWC-0.75 x 1.5-316L
3/4" x 2"	6.500	3.250	1.125	316L SST7-54WWC-0.75 x 2-316L
1" x 1.5"	6.000	3.000	1.125	316L SST7-54WWC-1 x 1.5-316L
1" x 2"	6.500	3.250	1.250	316L SST7-54WWC-1 x 2-316L
1.5" x 2"	6.500	3.250	1.500	316L SST7-54WWC-1.5 x 2-316L

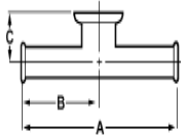

SST7-54MP-- Instrument Tee-- All Ends Clamp (ASME-BPE)				
Tube OD (Size)	A	B	C	Part Number
1/2" x 3/4"	5.250	2.625	0.875	316L SST7-54MP-0.50 x 0.75-316L
1/2" x 1"	5.500	2.750	0.875	316L SST7-54MP-0.50 x 1-316L
1/2" x 1.5"	6.000	3.000	0.875	316L SST7-54MP-0.50 x 1.5-316L
1/2" x 2"	6.500	3.250	1.000	316L SST7-54MP-0.50 x 2-316L
3/4" x 1"	5.500	2.750	1.000	316L SST7-54MP-0.75 x 1-316L
3/4" x 1.5"	6.000	3.000	1.000	316L SST7-54MP-0.75 x 1.5-316L
3/4" x 2"	6.500	3.250	1.125	316L SST7-54MP-0.75 x 2-316L
1" x 1.5"	6.000	3.000	1.125	316L SST7-54MP-1 x 1.5-316L
1" x 2"	6.500	3.250	1.250	316L SST7-54MP-1 x 2-316L
1.5" x 2"	6.500	3.250	1.500	316L SST7-54MP-1.5 x 2-316L

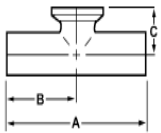

SST7WWCS--- Short Outlet Tee (ASME-BPE)				
Tube OD (Size)	A	B	C	Part Number
1/2"	3.750	1.875	1.000	316L SST7WWCS-0.50-316L
3/4"	4.000	2.000	1.125	316L SST7WWCS-0.75-316L
1"	4.250	2.000	1.125	316L SST7WWCS-1-316L
1.5"	4.750	2.125	1.375	316L SST7WWCS-1.5-316L
2"	5.750	2.875	1.625	316L SST7WWCS-2-316L
2.5"	6.250	3.125	1.875	316L SST7WWCS-2.5-316L
3"	6.750	3.375	2.125	316L SST7WWCS-3-316L
4"	8.250	4.125	2.750	316L SST7WWCS-4-316L

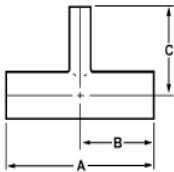

SST7RWWW--- Reducing Weld Bio-Pharm Tee				
Tube OD (Size)	A	B	C	Part Number
3/4" x 1/2"	4.000	2.000	2.000	316L SST7RWWW- 0.75 x 0.50- 316L
1" x 1/2"	4.250	2.125	2.125	316L SST7RWWW- 1 x 0.50- 316L
1" x 3/4"	4.250	2.125	2.125	316L SST7RWWW- 1 x 0.75- 316L
1.5" x 1/2"	4.750	2.375	2.375	316L SST7RWWW- 1.5 x 0.50- 316L
1.5" x 3/4"	4.750	2.375	2.375	316L SST7RWWW- 1.5 x 0.75- 316L
1.5" x 1"	4.750	2.375	2.375	316L SST7RWWW- 1.5 x 1- 316L
2" x 1"	5.750	2.875	2.625	316L SST7RWWW- 2 x 1- 316L
2" x 1.5"	5.750	2.875	2.625	316L SST7RWWW- 2 x 1.5- 316L
2.5" x 2"	6.250	3.125	2.875	316L SST7RWWW- 2.5 x 2- 316L
3" x 2"	6.750	3.375	3.125	316L SST7RWWW- 3 x 2- 316L
3" x 2.5"	6.750	3.375	3.125	316L SST7RWWW- 3 x 2.5- 316L
4" x 2"	8.250	4.125	3.875	316L SST7RWWW- 4 x 2- 316L
4" x 2.5"	8.250	4.125	3.875	316L SST7RWWW- 4 x 2.5- 316L
4" x 3"	8.250	4.125	3.875	316L SST7RWWW- 4 x 3- 316L

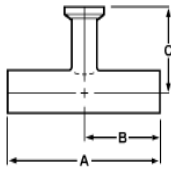

SST7RWWC--- Tee--Reducing Weld on Each Run x Clamp on Branch (ASME-BPE)				
Tube OD (Size)	A	B	C	Part Number
3/4" x 1/2"	4.000	2.000	2.500	316L SST7RWWC- 0.75 x 0.50- 316L
1" x 1/2"	4.250	2.125	2.625	SST7RWWC- 1 x 0.50- 316L
1" x 3/4"	4.250	2.125	2.625	SST7RWWC- 1 x 0.75- 316L
1.5" x 1/2"	4.750	2.375	2.875	SST7RWWC- 1.5 x 0.50- 316L
1.5" x 3/4"	4.750	2.375	2.875	SST7RWWC- 1.5 x 0.75- 316L
1.5" x 1"	4.750	2.375	2.875	SST7RWWC- 1.5 x 1- 316L
2" x 1"	5.750	2.875	3.125	SST7RWWC- 2 x 1- 316L
2" x 1.5"	5.750	2.875	3.125	SST7RWWC- 2 x 1.5- 316L
2.5" x 2"	6.250	3.125	3.375	SST7RWWC- 2.5 x 2- 316L
3" x 2"	6.750	3.375	3.625	SST7RWWC- 3 x 2- 316L
3" x 2.5"	6.750	3.375	3.625	SST7RWWC- 3 x 2.5- 316L
4" x 2"	8.250	4.125	4.375	SST7RWWC- 4 x 2- 316L
4" x 2.5"	8.250	4.125	4.375	SST7RWWC- 4 x 2.5- 316L
4" x 3"	8.250	4.125	4.375	SST7RWWC- 4 x 3- 316L

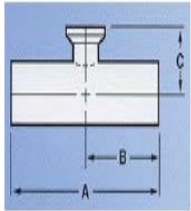

SST7RWWCs---Short Outlet Reducing Tee with Clamp on Branch x Weld on Each Run (ASME-BPE)				
Tube OD (Size)	A	B	C	Part Number
3/4" x 1/2"	4.000	2.000	1.000	316L SST7RWWCs- 0.75 x 0.50- 316L
1" x 1/2"	4.250	2.125	1.125	SST7RWWCs- 1 x 0.50- 316L
1" x 3/4"	4.250	2.125	1.125	SST7RWWCs- 1 x 0.75- 316L
1.5" x 1/2"	4.750	2.375	1.375	SST7RWWCs- 1.5 x 0.50- 316L
1.5" x 3/4"	4.750	2.375	1.375	SST7RWWCs- 1.5 x 0.75- 316L
1.5" x 1"	4.750	2.375	1.375	SST7RWWCs- 1.5 x 1- 316L
2" x 1"	5.750	2.875	1.625	SST7RWWCs- 2 x 1- 316L
2" x 1.5"	5.750	2.875	1.625	SST7RWWCs- 2 x 1.5- 316L
2.5" x 2"	6.250	3.125	1.875	SST7RWWCs- 2.5 x 2- 316L
3" x 2"	6.750	3.375	2.125	SST7RWWCs- 3 x 2- 316L
3" x 2.5"	6.750	3.375	2.125	SST7RWWCs- 3 x 2.5- 316L
4" x 2"	8.250	4.125	2.625	SST7RWWCs- 4 x 2- 316L
4" x 2.5"	8.250	4.125	2.625	SST7RWWCs- 4 x 2.5- 316L
4" x 3"	8.250	4.125	2.625	SST7RWWCs- 4 x 3- 316L

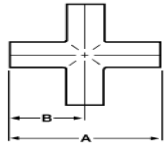

SST9WWWW--- Weld Bio-Pharm Cross (ASME-BPE)				
Tube OD (Size)	A	B		Part Number
1/2"	3.750	1.875		316L SST9WWWW-0.50-316L
3/4"	4.000	2.000		SST9WWWW-0.75-316L
1"	4.250	2.125		SST9WWWW-1-316L
1.5"	4.750	2.375		SST9WWWW-1.5-316L
2"	5.750	2.875		SST9WWWW-2-316L
2.5"	6.250	3.125		SST9WWWW-2.5-316L
3"	6.750	3.375		SST9WWWW-3-316L
4"	8.250	4.125		SST9WWWW-4-316L

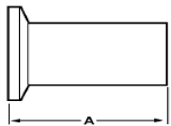

SST14AM7--- Bio-Pharm Ferrule (ASME-BPE)			
Tube OD (Size)	A		Part Number
1/2"	1.750		316L SST14AM7-0.50-316L
3/4"	1.750		SST14AM7-0.75-316L
1"	1.750		SST14AM7-1-316L
1.5"	1.750		SST14AM7-1.5-316L
2"	2.250		SST14AM7-2-316L
2.5"	2.250		SST14AM7-2.5-316L
3"	2.250		SST14AM7-3-316L
4"	2.250		SST14AM7-4-316L

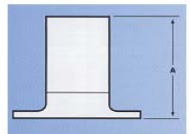

SST14VBA---Stub End-Type "A"			
Tube OD (Size)	A		Part Number
1/2"	1.625		316L SST14VBA-0.50-316L
3/4"	1.687		SST14VBA-0.75-316L
1"	2.000		SST14VBA-1-316L
1.5"	2.875		SST14VBA-1.5-316L
2"	3.625		SST14VBA-2-316L
2.5"	4.125		SST14VBA-2.5-316L
3"	5.000		SST14VBA-3-316L
4"	6.187		SST14VBA-4-316L

Note:
Not to
BPE
Dimension

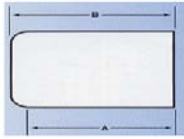

SST16W--- Weld Cap				
Tube OD (Size)	A	B		Part Number
1/2"	1.500	1.687		316L SST16W-0.50-316L
3/4"	1.500	1.687		SST16W-0.75-316L
1"	1.500	1.687		SST16W-1-316L
1.5"	1.500	1.919		SST16W-1.5-316L
2"	1.500	2.044		SST16W-2-316L
2.5"	1.500	2.015		SST16W-2.5-316L
3"	1.750	2.500		SST16W-3-316L
4"	2.500	3.056		SST16W-4-316L

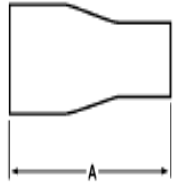

SST31E--- Weld Bio-Pharm <u>Concentric</u> Reducer (ASME-BPE)				
Tube OD (Size)	A			Part Number
3/4" x 1/2"	4.000			316L SST31E- 0.75 x 0.50- 316L
1" x 1/2"	4.500			SST31E- 1 x 0.50- 316L
1" x 3/4"	4.000			SST31E- 1 x 0.75- 316L
1.5" x 1/2"	5.500			SST31E- 1.5 x 0.50- 316L
1.5" x 3/4"	5.000			SST31E- 1.5 x 0.75- 316L
1.5" x 1"	5.000			SST31E- 1.5 x 1- 316L
2" x 1"	7.250			SST31E- 2 x 1- 316L
2" x 1.5"	5.250			SST31E- 2 x 1.5- 316L
2.5" x 2"	5.500			SST31E- 2.5 x 2- 316L
3" x 2"	7.500			SST31E- 3 x 2- 316L
3" x 2.5"	5.500			SST31E- 3 x 2.5- 316L
4" x 2"	11.75			SST31E- 4 x 2- 316L
4" x 2.5"	9.750			SST31E- 4 x 2.5- 316L
4" x 3"	7.750			SST31E- 4 x 3- 316L

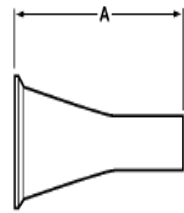

SST31CE--- Clamp (Large End) x Weld Concentric Reducer (ASME-BPE)				
Tube OD (Size)	A			Part Number
3/4" x 1/2"	3.000			316L SST31CE- 0.75 x 0.50- 316L
1" x 1/2"	3.500			SST31CE- 1 x 0.50- 316L
1" x 3/4"	3.000			SST31CE- 1 x 0.75- 316L
1.5" x 1/2"	4.500			SST31CE- 1.5 x 0.50- 316L
1.5" x 3/4"	4.000			SST31CE- 1.5 x 0.75- 316L
1.5" x 1"	4.000			SST31CE- 1.5 x 1- 316L
2" x 1"	6.000			SST31CE- 2 x 1- 316L
2" x 1.5"	4.000			SST31CE- 2 x 1.5- 316L
2.5" x 2"	4.250			SST31CE- 2.5 x 2- 316L
3" x 2"	6.250			SST31CE- 3 x 2- 316L
3" x 2.5"	4.250			SST31CE- 3 x 2.5- 316L
4" x 2"	10.38			SST31CE- 4 x 2- 316L
4" x 2.5"	8.375			SST31CE- 4 x 2.5- 316L
4" x 3"	6.375			SST31CE- 4 x 3- 316L

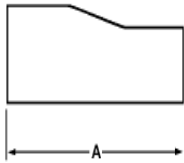

SST32E--- Weld Bio-Pharm <u>Eccentric</u> Reducer (ASME-BPE)				
Tube OD (Size)	A			Part Number
3/4" x 1/2"	4.000			316L SST32E- 0.75 x 0.50- 316L
1" x 1/2"	4.500			SST32E- 1 x 0.50- 316L
1" x 3/4"	4.000			SST32E- 1 x 0.75- 316L
1.5" x 1/2"	5.500			SST32E- 1.5 x 0.50- 316L
1.5" x 3/4"	5.000			SST32E- 1.5 x 0.75- 316L
1.5" x 1"	5.000			SST32E- 1.5 x 1- 316L
2" x 1"	7.250			SST32E- 2 x 1- 316L
2" x 1.5"	5.250			SST32E- 2 x 1.5- 316L
2.5" x 2"	5.500			SST32E- 2.5 x 2- 316L
3" x 2"	7.500			SST32E- 3 x 2- 316L
3" x 2.5"	5.500			SST32E- 3 x 2.5- 316L
4" x 2"	11.75			SST32E- 4 x 2- 316L
4" x 2.5"	9.750			SST32E- 4 x 2.5- 316L
4" x 3"	7.750			SST32E- 4 x 3- 316L

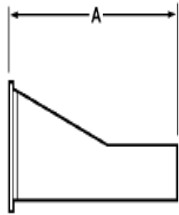

SST32CE--- Clamp (Large End) x Weld Eccentric Reducer (ASME-BPE)			
Tube OD (Size)	A		Part Number
3/4" x 1/2"	3.000		316L SST32CE- 0.75 x 0.50- 316L
1" x 1/2"	3.500		SST32CE- 1 x 0.50- 316L
1" x 3/4"	3.000		SST32CE- 1 x 0.75- 316L
1.5" x 1/2"	4.500		SST32CE- 1.5 x 0.50- 316L
1.5" x 3/4"	4.000		SST32CE- 1.5 x 0.75- 316L
1.5" x 1"	4.000		SST32CE- 1.5 x 1- 316L
2" x 1"	6.000		SST32CE- 2 x 1- 316L
2" x 1.5"	4.000		SST32CE- 2 x 1.5- 316L
2.5" x 2"	4.250		SST32CE- 2.5 x 2- 316L
3" x 2"	6.250		SST32CE- 3 x 2- 316L
3" x 2.5"	4.250		SST32CE- 3 x 2.5- 316L
4" x 2"	10.38		SST32CE- 4 x 2- 316L
4" x 2.5"	8.375		SST32CE- 4 x 2.5- 316L
4" x 3"	6.375		SST32CE- 4 x 3- 316L

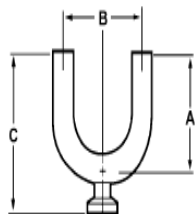

SSTUBWWC--- BOTTOM Outlet Use Point				
Tube OD (Size)	A	B	C	Part Number
3/4" x 1/2"	3.000	4.500	3.900	316L SSTUBWWC- 0.75 x 0.50-316L
1" x 1/2"	3.000	3.000	4.030	SSTUBWWC- 1 x 0.50-316L
1" x 3/4"	3.000	3.000	4.030	SSTUBWWC- 1 x 0.75-316L
1.5" x 1/2"	4.500	4.500	5.780	SSTUBWWC- 1.5 x 0.50-316L
1.5" x 3/4"	4.500	4.500	5.780	SSTUBWWC- 1.5 x 0.75-316L
1.5" x 1"	4.500	4.500	5.780	SSTUBWWC- 1.5 x 1-316L
2" x 1/2"	5.000	6.000	6.530	SSTUBWWC- 2 x 0.50-316L
2" x 3/4"	5.000	6.000	6.530	SSTUBWWC- 2 x 0.75-316L
2" x 1"	5.000	6.000	6.530	SSTUBWWC- 2 x 1-316L
2" x 1.5"	5.000	7.000	6.530	SSTUBWWC- 2 x 1.5-316L
2.5" x 1/2"	5.750	7.500	7.530	SSTUBWWC- 2.5 x 0.50-316L
2.5" x 3/4"	5.750	7.500	7.530	SSTUBWWC- 2.5 x 0.75-316L
2.5" x 1"	5.750	7.500	7.560	SSTUBWWC- 2.5 x 1-316L
2.5" x 1.5"	5.750	7.500	7.580	SSTUBWWC- 2.5 x 1.5-316L
2.5" x 2"	5.750	7.500	7.600	SSTUBWWC- 2.5 x 2-316L
3" x 1/2"	6.500	9.000	8.530	SSTUBWWC- 3 x 0.50-316L
3" x 3/4"	6.500	9.000	8.530	SSTUBWWC- 3 x 0.75-316L
3" x 1"	6.500	9.000	8.560	SSTUBWWC- 3 x 1-316L
3" x 1.5"	6.500	9.000	8.560	SSTUBWWC- 3 x 1.5-316L
3" x 2"	6.500	9.000	8.600	SSTUBWWC- 3 x 2-316L
3" x 2.5"	6.500	9.000	8.600	SSTUBWWC- 3 x 2.5-316L
4" x 1/2"	8.500	12.00	11.03	SSTUBWWC- 4 x 0.50-316L
4" x 3/4"	8.500	12.00	11.03	SSTUBWWC- 4 x 0.75-316L
4" x 1"	8.500	12.00	11.06	SSTUBWWC- 4 x 1-316L
4" x 1.5"	8.500	12.00	11.10	SSTUBWWC- 4 x 1.5-316L
4" x 2"	8.500	12.00	11.08	SSTUBWWC- 4 x 2-316L
4" x 2.5"	8.500	12.00	11.10	SSTUBWWC- 4 x 2.5-316L
4" x 3"	8.500	12.00	11.10	SSTUBWWC- 4 x 3-316L

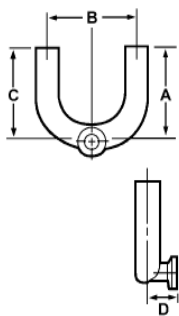

SSTUSWWC--- Side Outlet Use Point					
Tube OD (Size)	A	B	C	D	Part Number
3/4" x 1/2"	3.000	4.500	3.125	1.125	316L SSTUSWWC- 0.75 x 0.50-316L
1" x 1/2"	3.000	3.000	3.250	1.250	SSTUSWWC- 1 x 0.50-316L
1" x 3/4"	3.000	3.000	3.125	1.250	SSTUSWWC- 1 x 0.75-316L
1.5" x 1/2"	4.500	4.500	5.000	1.250	SSTUSWWC- 1.5 x 0.50-316L
1.5" x 3/4"	4.500	4.500	4.875	1.250	SSTUSWWC- 1.5 x 0.75-316L
1.5" x 1"	4.500	4.500	4.750	1.250	SSTUSWWC- 1.5 x 1-316L
2" x 1/2"	5.000	6.000	5.750	1.750	SSTUSWWC- 2 x 0.50-316L
2" x 3/4"	5.000	6.000	5.625	1.750	SSTUSWWC- 2 x 0.75-316L
2" x 1"	5.000	6.000	5.550	1.750	SSTUSWWC- 2 x 1-316L
2" x 1.5"	5.000	7.000	5.250	1.750	SSTUSWWC- 2 x 1.5-316L
2.5" x 1/2"	5.750	7.500	6.750	2.000	SSTUSWWC- 2.5 x 0.50-316L
2.5" x 3/4"	5.750	7.500	6.625	2.000	SSTUSWWC- 2.5 x 0.75-316L
2.5" x 1"	5.750	7.500	6.500	2.000	SSTUSWWC- 2.5 x 1-316L
2.5" x 1.5"	5.750	7.500	6.250	2.000	SSTUSWWC- 2.5 x 1.5-316L
2.5" x 2"	5.750	7.500	6.000	2.000	SSTUSWWC- 2.5 x 2-316L
3" x 1/2"	6.500	9.000	7.750	2.250	SSTUSWWC- 3 x 0.50-316L
3" x 3/4"	6.500	9.000	7.625	2.250	SSTUSWWC- 3 x 0.75-316L
3" x 1"	6.500	9.000	7.500	2.250	SSTUSWWC- 3 x 1-316L
3" x 1.5"	6.500	9.000	7.250	2.250	SSTUSWWC- 3 x 1.5-316L
3" x 2"	6.500	9.000	7.000	2.250	SSTUSWWC- 3 x 2-316L
3" x 2.5"	6.500	9.000	6.750	2.250	SSTUSWWC- 3 x 2.5-316L
4" x 1/2"	8.500	12.00	10.25	2.750	SSTUSWWC- 4 x 0.50-316L
4" x 3/4"	8.500	12.00	10.13	2.750	SSTUSWWC- 4 x 0.75-316L
4" x 1"	8.500	12.00	10.00	2.750	SSTUSWWC- 4 x 1-316L
4" x 1.5"	8.500	12.00	9.750	2.750	SSTUSWWC- 4 x 1.5-316L
4" x 2"	8.500	12.00	9.500	2.750	SSTUSWWC- 4 x 2-316L
4" x 2.5"	8.500	12.00	9.250	2.750	SSTUSWWC- 4 x 2.5-316L
4" x 3"	8.500	12.00	9.000	2.750	SSTUSWWC- 4 x 3-316L

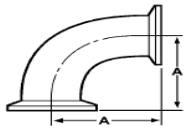

SSBP2CMP---- 90° Clamp Elbows			
Tube OD (Size)	A		Part Number
1/2"	3.500		316L SSBP2CMP-0.50-316L
3/4"	3.500		SSBP2CMP-0.75-316L
1"	2.000		SSBP2CMP-1-316L
1.5"	2.750		SSBP2CMP-1.5-316L
2"	3.500		SSBP2CMP-2-316L
2.5"	4.250		SSBP2CMP-2.5-316L
3"	5.000		SSBP2CMP-3-316L
4"	6.625		SSBP2CMP-4-316L

Note:
Not to
BPE
Dimension

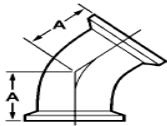

SSBP2KMP---- 45° Clamp Elbows			
Tube OD (Size)	A		Part Number
1/2"	2.750		316L SSBP2KMP-0.50-316L
3/4"	2.750		SSBP2KMP-0.75-316L
1"	1.125		SSBP2KMP-1-316L
1.5"	1.437		SSBP2KMP-1.5-316L
2"	1.750		SSBP2KMP-2-316L
2.5"	2.062		SSBP2KMP-2.5-316L
3"	2.375		SSBP2KMP-3-316L
4"	3.125		SSBP2KMP-4-316L

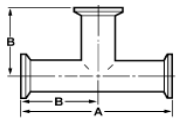

SSBP7MP---- Clamp Tees			
Tube OD (Size)	A	B	Part Number
1/2"	4.500	2.250	316L SSBP7MP-0.50-316L
3/4"	4.750	2.375	SSBP7MP-0.75-316L
1"	5.250	2.625	SSBP7MP-1-316L
1.5"	5.750	2.875	SSBP7MP-1.5-316L
2"	6.750	3.375	SSBP7MP-2-316L
2.5"	7.250	3.625	SSBP7MP-2.5-316L
3"	7.750	3.875	SSBP7MP-3-316L
4"	9.500	4.750	SSBP7MP-4-316L

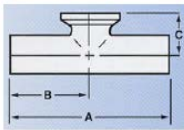

SSBP7MPS--- Short Outlet Clamp Tee				
Tube OD (Size)	A	B	C	Part Number
1/2"	4.500	2.250	1.000	316L SSBP7MPS-0.50-316L
3/4"	4.750	2.375	1.125	SSBP7MPS-0.75-316L
1"	5.250	2.625	1.125	SSBP7MPS-1-316L
1.5"	5.750	2.875	1.375	SSBP7MPS-1.5-316L
2"	6.750	3.375	1.625	SSBP7MPS-2-316L
2.5"	7.250	3.625	1.875	SSBP7MPS-2.5-316L
3"	7.750	3.875	2.125	SSBP7MPS-3-316L
4"	9.500	4.750	2.75	SSBP7MPS-4-316L

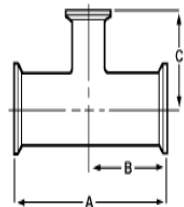

SSBP7RMP--- Clamp Reducing Tees				
Tube OD (Size)	A	B	C	Part Number
3/4" x 1/2"	5.000	2.500	2.500	316L SSBP7RMP- 0.75 x 0.50- 316L
1" x 1/2"	5.250	2.625	2.625	SSBP7RMP- 1 x 0.50- 316L
1" x 3/4"	5.250	2.625	2.625	SSBP7RMP- 1 x .75- 316L
1.5" x 1/2"	5.750	2.875	2.875	SSBP7RMP- 1.5 x 0.50- 316L
1.5" x 3/4"	5.750	2.875	2.875	SSBP7RMP- 1.5 x .75- 316L
1.5" x 1"	5.750	2.875	2.875	SSBP7RMP- 1.5 x 1- 316L
2" x 1/2"	6.750	3.375	3.125	SSBP7RMP- 2 x 0.50- 316L
2" x 3/4"	6.750	3.375	3.125	SSBP7RMP- 2 x .75- 316L
2" x 1"	6.750	3.375	3.125	SSBP7RMP- 2 x 1- 316L
2" x 1.5"	6.750	3.375	3.125	SSBP7RMP- 2 x 1.5- 316L
2.5" x 2"	7.250	3.625	3.375	SSBP7RMP- 2.5 x 2- 316L
3" x 1"	7.750	3.875	3.625	SSBP7RMP- 3 x 1- 316L
3" x 1.5"	7.750	3.875	3.625	SSBP7RMP- 3 x 1.5- 316L
3" x 2"	7.750	3.875	3.625	SSBP7RMP- 3 x 2- 316L
3" x 2.5"	7.750	3.875	3.625	SSBP7RMP- 3 x 2.5- 316L
4" x 1.5"	9.500	4.750	4.125	SSBP7RMP- 4 x 1.5- 316L
4" x 2"	9.500	4.750	4.375	SSBP7RMP- 4 x 2- 316L
4" x 2.5"	9.500	4.750	4.375	SSBP7RMP- 4 x 2.5- 316L
4" x 3"	9.500	4.750	4.375	SSBP7RMP- 4 x 3- 316L

Note:
Not to
BPE
Dimension

SSBP7RMPS--Short Outlet Clamp Reducing Tees

Tube OD (Size)	A	B	C	Part Number
3/4" x 1/2"	5.000	2.500	1.000	SSBP7RMPS-0.75 x 0.50-316L
1" x 1/2"	5.250	2.625	1.125	SSBP7RMPS-1 x 0.50-316L
1" x 3/4"	5.250	2.625	1.125	SSBP7RMPS-1 x .75-316L
1.5" x 1/2"	5.750	2.875	1.375	SSBP7RMPS-1.5 x 0.50-316L
1.5" x 3/4"	5.750	2.875	1.375	SSBP7RMPS-1.5 x .75-316L
1.5" x 1"	5.750	2.875	1.375	SSBP7RMPS-1.5 x 1-316L
2" x 1/2"	6.750	3.375	1.625	SSBP7RMPS-2 x 0.50-316L
2" x 3/4"	6.750	3.375	1.625	SSBP7RMPS-2 x .75-316L
2" x 1"	6.750	3.375	1.625	SSBP7RMPS-2 x 1-316L
2" x 1.5"	6.750	3.375	1.625	SSBP7RMPS-2 x 1.5-316L
2.5" x 2"	7.250	3.625	1.875	SSBP7RMPS-2.5 x 2-316L
3" x 1"	7.750	3.875	2.125	SSBP7RMPS-3 x 1-316L
3" x 1.5"	7.750	3.875	2.125	SSBP7RMPS-3 x 1.5-316L
3" x 2"	7.750	3.875	2.125	SSBP7RMPS-3 x 2-316L
3" x 2.5"	7.750	3.875	2.125	SSBP7RMPS-3 x 2.5-316L
4" x 1"	9.500	4.750	2.625	SSBP7RMPS-4 x 1-316L
4" x 1.5"	9.500	4.750	2.625	SSBP7RMPS-4 x 1.5-316L
4" x 2"	9.500	4.750	2.625	SSBP7RMPS-4 x 2-316L
4" x 2.5"	9.500	4.750	2.625	SSBP7RMPS-4 x 2.5-316L
4" x 3"	9.500	4.750	2.625	SSBP7RMPS-4 x 3-316L

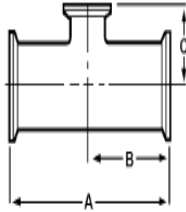

Note:
Not to
BPE
Dimension

SST7-54WWC-- Instrument Tee-- Butt weld on Branches x Clamp on Run

Tube OD (Size)	A	B	C	Part Number
1/2" x 3/4"	4.250	2.125	0.875	SST7-54WWC-0.50 x 0.75-316L
1/2" x 1"	4.500	2.250	0.875	SST7-54WWC-0.50 x 1-316L
1/2" x 1.5"	5.000	2.500	0.875	SST7-54WWC-0.50 x 1.5-316L
1/2" x 2"	5.500	2.750	1.000	SST7-54WWC-0.50 x 2-316L
3/4" x 1"	4.500	2.250	1.000	SST7-54WWC-0.75 x 1-316L
3/4" x 1.5"	5.000	2.500	1.000	SST7-54WWC-0.75 x 1.5-316L
3/4" x 2"	5.500	2.750	1.125	SST7-54WWC-0.75 x 2-316L
1" x 1.5"	5.000	2.500	1.125	SST7-54WWC-1 x 1.5-316L
1" x 2"	5.500	2.750	1.250	SST7-54WWC-1 x 2-316L
1.5" x 2"	5.500	2.750	1.500	SST7-54WWC-1.5 x 2-316L

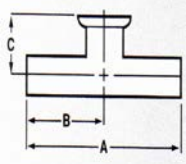

SST7-54MP-- Instrument Tee-- All Ends Clamp

Tube OD (Size)	A	B	C	Part Number
1/2" x 3/4"	5.250	2.625	0.875	SST7-54MP-0.50 x 0.75-316L
1/2" x 1"	5.500	2.750	0.875	SST7-54MP-0.50 x 1-316L
1/2" x 1.5"	6.000	3.000	0.875	SST7-54MP-0.50 x 1.5-316L
1/2" x 2"	6.500	3.250	1.000	SST7-54MP-0.50 x 2-316L
3/4" x 1"	5.500	2.750	1.000	SST7-54MP-0.75 x 1-316L
3/4" x 1.5"	6.000	3.000	1.000	SST7-54MP-0.75 x 1.5-316L
3/4" x 2"	6.500	3.250	1.125	SST7-54MP-0.75 x 2-316L
1" x 1.5"	6.000	3.000	1.125	SST7-54MP-1 x 1.5-316L
1" x 2"	6.500	3.250	1.250	SST7-54MP-1 x 2-316L
1.5" x 2"	6.500	3.250	1.500	SST7-54MP-1.5 x 2-316L

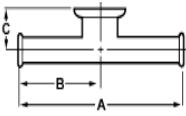

Note:
Not to
BPE
Dimension

SSBP9MP-- Clamp Cross

Tube OD (Size)	A	B	Part Number
1/2"	4.500	2.250	SSBP9MP-0.50-316L
3/4"	4.750	2.375	SSBP9MP-0.75-316L
1"	5.250	2.625	SSBP9MP-1-316L
1.5"	5.750	2.875	SSBP9MP-1.5-316L
2"	6.750	3.375	SSBP9MP-2-316L
2.5"	7.250	3.625	SSBP9MP-2.5-316L
3"	7.750	3.875	SSBP9MP-3-316L
4"	9.500	4.750	SSBP9MP-4-316L

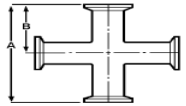

Note:
Not to
BPE
Dimension

SST14AM7-- Bio-Pharm Ferrule

Tube OD (Size)	A	Part Number
1/2"	1.750	SST14AM7-0.50-316L
3/4"	1.750	SST14AM7-0.75-316L
1"	1.750	SST14AM7-1-316L
1.5"	1.750	SST14AM7-1.5-316L
2"	2.250	SST14AM7-2-316L
2.5"	2.250	SST14AM7-2.5-316L
3"	2.250	SST14AM7-3-316L
4"	2.250	SST14AM7-4-316L

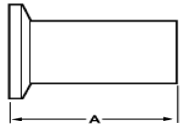

Note:
Not to
BPE
Dimension

SSBP14MPHR--- Clamp End Rubber Hose Adapter

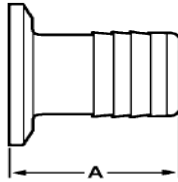

Tube OD (Size)	A	Part Number
		316L
1/2" x 1/4"	1.688	SSBP14MPHR- 0.50 x 0.25- 316L
1/2" x 3/8"	1.688	SSBP14MPHR- 0.50 x 0.375- 316L
1/2" x 1/2"	1.688	SSBP14MPHR- 0.50 x 0.50- 316L
3/4" x 1/4"	1.688	SSBP14MPHR- 0.75 x 0.25- 316L
3/4" x 3/8"	1.688	SSBP14MPHR- 0.75 x 0.375- 316L
3/4" x 1/2"	1.688	SSBP14MPHR- 0.75 x 0.50- 316L
3/4" x 3/4"	1.688	SSBP14MPHR- 0.75 x 0.75- 316L
1" x 1"	1.688	SSBP14MPHR- 1 x 1- 316L
1.5" x 1.5"	1.688	SSBP14MPHR- 1.5 x 1.5- 316L
2" x 2"	2.313	SSBP14MPHR- 2 x 2- 316L
2.5" x 2.5"	2.344	SSBP14MPHR- 2.5 x 2.5- 316L
3" x 3"	3.094	SSBP14MPHR- 3 x 3- 316L
4" x 4"	3.406	SSBP14MPHR- 4 x 4- 316L

SSBP16AMP--- Solid End Cap

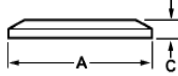

Tube OD (Size)	A	B	Part Number
			316L
1/2"-- 3/4"	0.984	0.188	SSBP16AMP-0.50-0.75-316L
1"-- 1.5"	1.984	0.250	SSBP16AMP-1-1.5-316L
2"	2.516	0.250	SSBP16AMP-2-316L
2.5"	3.047	0.250	SSBP16AMP-2.5-316L
3"	3.578	0.250	SSBP16AMP-3-316L
4"	4.672	0.313	SSBP16AMP-4-316L

Note: Not to BPE Dimension

SSBP21MP-- Clamp x Male Adapter (MNPT)

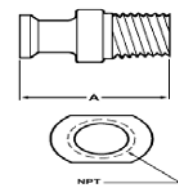

Tube OD (Size)	A	Part Number
		316L
1/2" x 1/4"	2.000	SSBP21MP- 0.50 x 0.25- 316L
1/2" x 3/8"	2.000	SSBP21MP- 0.50 x 0.375- 316L
1/2" x 1/2"	2.000	SSBP21MP- 0.50 x 0.50- 316L
3/4" x 1/4"	2.000	SSBP21MP- 0.75 x 0.25- 316L
3/4" x 3/8"	2.000	SSBP21MP- 0.75 x 0.375- 316L
3/4" x 1/2"	2.000	SSBP21MP- 0.75 x 0.50- 316L
3/4" x 3/4"	2.000	SSBP21MP- 0.75 x 0.75- 316L
1" x 1"	2.250	SSBP21MP- 1 x 1- 316L
1.5" x 1.5"	2.438	SSBP21MP- 1.5 x 1.5- 316L
2" x 2"	2.656	SSBP21MP- 2 x 2- 316L
2.5" x 2.5"	3.281	SSBP21MP- 2.5 x 2.5- 316L
3" x 3"	3.500	SSBP21MP- 3 x 3- 316L
4" x 4"	3.813	SSBP21MP- 4 x 4- 316L

SSBP22MP-- Clamp x Female Adapter (FNPT)

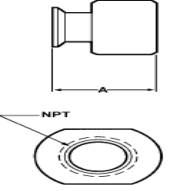

Tube OD (Size)	A	Part Number
		316L
1/2" x 1/4"	1.500	SSBP22MP- 0.50 x 0.25- 316L
1/2" x 3/8"	1.500	SSBP22MP- 0.50 x 0.375- 316L
1/2" x 1/2"	1.500	SSBP22MP- 0.50 x 0.50- 316L
3/4" x 1/4"	1.500	SSBP22MP- 0.75 x 0.25- 316L
3/4" x 3/8"	1.500	SSBP22MP- 0.75 x 0.375- 316L
3/4" x 1/2"	1.500	SSBP22MP- 0.75 x 0.50- 316L
3/4" x 3/4"	1.500	SSBP22MP- 0.75 x 0.75- 316L
1" x 1"	1.625	SSBP22MP- 1 x 1- 316L
1.5" x 1.5"	2.250	SSBP22MP- 1.5 x 1.5- 316L
2" x 2"	2.344	SSBP22MP- 2 x 2- 316L
2.5" x 2.5"	2.094	SSBP22MP- 2.5 x 2.5- 316L
3" x 3"	2.188	SSBP22MP- 3 x 3- 316L
4" x 4"	2.625	SSBP22MP- 4 x 4- 316L

SSBP31-14MP: Clamp x Clamp Concentric Reducer

Tube OD (Size)	A	Part Number
3/4" x 1/2"	2.000	SSBP31-14MP- 0.75 x 0.50- 316L
1" x 1/2"	2.500	SSBP31-14MP- 1 x 0.50- 316L
1" x 3/4"	2.000	SSBP31-14MP- 1 x 0.75- 316L
1.5" x 1/2"	3.500	SSBP31-14MP- 1.5 x 0.50- 316L
1.5" x 3/4"	3.000	SSBP31-14MP- 1.5 x 0.75- 316L
1.5" x 1"	3.000	SSBP31-14MP- 1.5 x 1- 316L
2" x 1/2"	5.500	SSBP31-14MP- 2 x 0.50- 316L
2" x 3/4"	5.000	SSBP31-14MP- 2 x 0.75- 316L
2" x 1"	5.000	SSBP31-14MP- 2 x 1- 316L
2" x 1.5"	3.000	SSBP31-14MP- 2 x 1.5- 316L
2.5" x 2"	3.000	SSBP31-14MP- 2.5 x 2- 316L
3" x 1.5"	7.000	SSBP31-14MP- 3 x 1.5- 316L
3" x 2"	5.000	SSBP31-14MP- 3 x 2- 316L
3" x 2.5"	3.000	SSBP31-14MP- 3 x 2.5- 316L
4" x 1.5"	11.13	SSBP31-14MP- 4 x 1.5- 316L
4" x 2"	9.125	SSBP31-14MP- 4 x 2- 316L
4" x 2.5"	7.125	SSBP31-14MP- 4 x 2.5- 316L
4" x 3"	5.125	SSBP31-14MP- 4 x 3- 316L

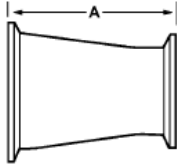

SSBP32-14MP: Clamp x Clamp Eccentric Reducer

Tube OD (Size)	A	Part Number
3/4" x 1/2"	2.000	SSBP32-14MP- 0.75 x 0.50- 316L
1" x 1/2"	2.500	SSBP32-14MP- 1 x 0.50- 316L
1" x 3/4"	2.000	SSBP32-14MP- 1 x 0.75- 316L
1.5" x 1/2"	3.500	SSBP32-14MP- 1.5 x 0.50- 316L
1.5" x 3/4"	3.000	SSBP32-14MP- 1.5 x 0.75- 316L
1.5" x 1"	3.000	SSBP32-14MP- 1.5 x 1- 316L
2" x 1/2"	7.000	SSBP32-14MP- 2 x 0.50- 316L
2" x 3/4"	6.000	SSBP32-14MP- 2 x 0.75- 316L
2" x 1"	5.000	SSBP32-14MP- 2 x 1- 316L
2" x 1.5"	3.000	SSBP32-14MP- 2 x 1.5- 316L
2.5" x 2"	3.000	SSBP32-14MP- 2.5 x 2- 316L
3" x 1.5"	7.000	SSBP32-14MP- 3 x 1.5- 316L
3" x 2"	5.000	SSBP32-14MP- 3 x 2- 316L
3" x 2.5"	3.000	SSBP32-14MP- 3 x 2.5- 316L
4" x 1.5"	11.13	SSBP32-14MP- 4 x 1.5- 316L
4" x 2"	9.125	SSBP32-14MP- 4 x 2- 316L
4" x 2.5"	7.125	SSBP32-14MP- 4 x 2.5- 316L
4" x 3"	5.125	SSBP32-14MP- 4 x 3- 316L

