



SANITARY SOLUTIONS^{INC.}

Bulldog Fittings...Bulldog Tuff.

Sanitary Solutions I-Line/Q-Line Fittings



Sanitary Solutions I-Line & Q-Line Various Fittings meet all 3A requirements

Sanitary Solutions I-Line & Q-Line Fittings Stocking Alloys: T304 or T316L

Sanitary Solutions I-Line & Q-Line Fittings Sizes: 1" – 8" OD Tube

Note: OD Tube and Pipe Sizes do not interchange!

Sanitary Solutions Bevel Seat/John Perry Fittings Sanitary Finish: 180 Grit Polish

Sanitary Solutions I-Line Fittings Part Number Breakdown:

| <u>SS</u> | <u>Part Number</u> | <u>Size</u> | <u>Alloy</u> |
|--------------------|--------------------|-------------|--------------|
| Sanitary Solutions | 14WI | 2" | 304 or 316L |
| | I = I-Line | | |

Sanitary Solutions Q-Line Fittings Part Number Breakdown:

| <u>SS</u> | <u>Part Number</u> | <u>Size</u> | <u>Alloy</u> |
|--------------------|--------------------|-------------|--------------|
| Sanitary Solutions | 14WQ | 2" | 304 or 316L |
| | Q = Q-Line | | |

www.sanitarysolutionsinc.com

Sanitary Solutions Inc.

53

1 - 888 - 909 - 3569

Prices are subject to change without notice; please call before you quote



SANITARY SOLUTIONS INC.

Bulldog Fittings...Bulldog Tuff.

SS2CI--- 90° Elbow with Female I-Line Ferrules on Both Ends, Polish ID/OD

| Tube OD (Size) | A | | Part Number 304 | Part Number 316L |
|----------------|-------|--|-----------------|------------------|
| 1" | 2.281 | | SS2CI-1-304 | SS2CI-1-316L |
| 1.5" | 3.188 | | SS2CI-1.5-304 | SS2CI-1.5-316L |
| 2" | 4.031 | | SS2CI-2-304 | SS2CI-2-316L |
| 2.5" | 4.906 | | SS2CI-2.5-304 | SS2CI-2.5-316L |
| 3" | 5.718 | | SS2CI-3-304 | SS2CI-3-316L |
| 4" | 7.344 | | SS2CI-4-304 | SS2CI-4-316L |
| 6" | 10.13 | | SS2CI-6-304 | SS2CI-6-316L |
| 8" | 13.13 | | SS2CI-8-304 | SS2CI-8-316L |



SS2EI--- 90° Elbow with Male I-Line Ferrules on Both Ends, Polish ID/OD

| Tube OD (Size) | A | | Part Number 304 | Part Number 316L |
|----------------|-------|--|-----------------|------------------|
| 1" | 2.093 | | SS2EI-1-304 | SS2EI-1-316L |
| 1.5" | 3.000 | | SS2EI-1.5-304 | SS2EI-1.5-316L |
| 2" | 3.781 | | SS2EI-2-304 | SS2EI-2-316L |
| 2.5" | 4.593 | | SS2EI-2.5-304 | SS2EI-2.5-316L |
| 3" | 5.406 | | SS2EI-3-304 | SS2EI-3-316L |
| 4" | 7.031 | | SS2EI-4-304 | SS2EI-4-316L |
| 6" | 9.940 | | SS2EI-6-304 | SS2EI-6-316L |
| 8" | 12.94 | | SS2EI-8-304 | SS2EI-8-316L |



SS2FI--- 90° Elbow with Male I-Line x Female I-Line on Each End, Polish ID/OD

| Tube OD (Size) | A | B | Part Number 304 | Part Number 316L |
|----------------|-------|-------|-----------------|------------------|
| 1" | 2.281 | 2.093 | SS2FI-1-304 | SS2FI-1-316L |
| 1.5" | 3.188 | 3.000 | SS2FI-1.5-304 | SS2FI-1.5-316L |
| 2" | 4.031 | 3.781 | SS2FI-2-304 | SS2FI-2-316L |
| 2.5" | 4.906 | 4.593 | SS2FI-2.5-304 | SS2FI-2.5-316L |
| 3" | 5.718 | 5.406 | SS2FI-3-304 | SS2FI-3-316L |
| 4" | 7.344 | 7.031 | SS2FI-4-304 | SS2FI-4-316L |
| 6" | 10.13 | 9.940 | SS2FI-6-304 | SS2FI-6-316L |
| 8" | 13.13 | 12.94 | SS2FI-8-304 | SS2FI-8-316L |



SS2HI--- 45° Elbow with Female I-Line Ferrules on Both Ends, Polish ID/OD

| Tube OD (Size) | A | | Part Number 304 | Part Number 316L |
|----------------|-------|--|-----------------|------------------|
| 1" | 1.225 | | SS2HI-1-304 | SS2HI-1-316L |
| 1.5" | 1.702 | | SS2HI-1.5-304 | SS2HI-1.5-316L |
| 2" | 2.040 | | SS2HI-2-304 | SS2HI-2-316L |
| 2.5" | 2.410 | | SS2HI-2.5-304 | SS2HI-2.5-316L |
| 3" | 2.781 | | SS2HI-3-304 | SS2HI-3-316L |
| 4" | 3.531 | | SS2HI-4-304 | SS2HI-4-316L |
| 6" | 4.690 | | SS2HI-6-304 | SS2HI-6-316L |
| 8" | 5.940 | | SS2HI-8-304 | SS2HI-8-316L |



www.sanitarysolutionsinc.com



SANITARY SOLUTIONS INC.

Bulldog Fittings...Bulldog Tuff.

SS2KI--- 45° Elbow with Female I-Line Ferrules on Both Ends, Polish ID/OD



| Tube OD (Size) | A | | Part Number 304 | Part Number 316L |
|----------------|-------|--|-----------------|------------------|
| 1" | 1.406 | | SS2KI-1-304 | SS2KI-1-316L |
| 1.5" | 1.888 | | SS2KI-1.5-304 | SS2KI-1.5-316L |
| 2" | 2.281 | | SS2KI-2-304 | SS2KI-2-316L |
| 2.5" | 2.718 | | SS2KI-2.5-304 | SS2KI-2.5-316L |
| 3" | 3.093 | | SS2KI-3-304 | SS2KI-3-316L |
| 4" | 3.844 | | SS2KI-4-304 | SS2KI-4-316L |
| 6" | 4.875 | | SS2KI-6-304 | SS2KI-6-316L |
| 8" | 6.125 | | SS2KI-8-304 | SS2KI-8-316L |

SS2PI--- 45° Elbow with Male I-Line x Female I-Line on Each End, Polish ID/OD



| Tube OD (Size) | A | B | Part Number 304 | Part Number 316L |
|----------------|-------|-------|-----------------|------------------|
| 1" | 1.406 | 1.225 | SS2PI-1-304 | SS2PI-1-316L |
| 1.5" | 1.888 | 1.702 | SS2PI-1.5-304 | SS2PI-1.5-316L |
| 2" | 2.281 | 2.040 | SS2PI-2-304 | SS2PI-2-316L |
| 2.5" | 2.718 | 2.410 | SS2PI-2.5-304 | SS2PI-2.5-316L |
| 3" | 3.093 | 2.781 | SS2PI-3-304 | SS2PI-3-316L |
| 4" | 3.844 | 3.531 | SS2PI-4-304 | SS2PI-4-316L |
| 6" | 4.875 | 4.690 | SS2PI-6-304 | SS2PI-6-316L |
| 8" | 6.125 | 5.940 | SS2PI-8-304 | SS2PI-8-316L |

SS7I--- TEE with Female I-Line Ferrule (All ENDS), Polish ID/OD

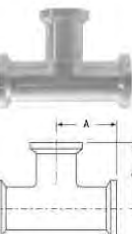

| Tube OD (Size) | A | Part Number 304 | Part Number 316L |
|----------------|-------|-----------------|------------------|
| 1" | 1.875 | SS7I-1-304 | SS7I-1-316L |
| 1.5" | 2.594 | SS7I-1.5-304 | SS7I-1.5-316L |
| 2" | 3.062 | SS7I-2-304 | SS7I-2-316L |
| 2.5" | 3.468 | SS7I-2.5-304 | SS7I-2.5-316L |
| 3" | 3.812 | SS7I-3-304 | SS7I-3-316L |
| 4" | 4.750 | SS7I-4-304 | SS7I-4-316L |
| 6" | 6.750 | SS7I-6-304 | SS7I-6-316L |
| 8" | 8.125 | SS7I-8-304 | SS7I-8-316L |



SANITARY SOLUTIONS INC.

Bulldog Fittings...Bulldog Tuff.

SS7AI--- TEE with a Female I-Line Ferrule on each Run x Male I-Line Ferrule on the Branch

| Tube OD (Size) | A | B | Part Number 304 | Part Number 316L |
|----------------|-------|-------|-----------------|------------------|
| 1" | 1.875 | 1.688 | SS7AI-1-304 | SS7AI-1-316L |
| 1.5" | 2.594 | 2.406 | SS7AI-1.5-304 | SS7AI-1.5-316L |
| 2" | 3.062 | 2.812 | SS7AI-2-304 | SS7AI-2-316L |
| 2.5" | 3.468 | 3.156 | SS7AI-2.5-304 | SS7AI-2.5-316L |
| 3" | 3.812 | 3.500 | SS7AI-3-304 | SS7AI-3-316L |
| 4" | 4.750 | 4.468 | SS7AI-4-304 | SS7AI-4-316L |
| 6" | 6.750 | 6.565 | SS7AI-6-304 | SS7AI-6-316L |
| 8" | 8.125 | 7.940 | SS7AI-8-304 | SS7AI-8-316L |

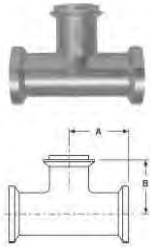

SS7BI--- TEE--- 15WI on 1 Run x 14WI on 1 Run x 15WI on Branch, Polish ID/OD

| Tube OD (Size) | A | B | Part Number 304 | Part Number 316L |
|----------------|-------|-------|-----------------|------------------|
| 1" | 1.875 | 1.688 | SS7BI-1-304 | SS7BI-1-316L |
| 1.5" | 2.594 | 2.406 | SS7BI-1.5-304 | SS7BI-1.5-316L |
| 2" | 3.062 | 2.812 | SS7BI-2-304 | SS7BI-2-316L |
| 2.5" | 3.468 | 3.156 | SS7BI-2.5-304 | SS7BI-2.5-316L |
| 3" | 3.812 | 3.500 | SS7BI-3-304 | SS7BI-3-316L |
| 4" | 4.750 | 4.468 | SS7BI-4-304 | SS7BI-4-316L |
| 6" | 6.750 | 6.565 | SS7BI-6-304 | SS7BI-6-316L |
| 8" | 8.125 | 7.940 | SS7BI-8-304 | SS7BI-8-316L |

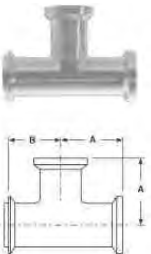

SS7EI--- TEE with a Male I-Line Ferrule on each Run x Female I-Line Ferrule on Branch

| Tube OD (Size) | A | B | Part Number 304 | Part Number 316L |
|----------------|-------|-------|-----------------|------------------|
| 1" | 1.688 | 1.875 | SS7EI-1-304 | SS7EI-1-316L |
| 1.5" | 2.406 | 2.594 | SS7EI-1.5-304 | SS7EI-1.5-316L |
| 2" | 2.812 | 3.062 | SS7EI-2-304 | SS7EI-2-316L |
| 2.5" | 3.156 | 3.468 | SS7EI-2.5-304 | SS7EI-2.5-316L |
| 3" | 3.500 | 3.812 | SS7EI-3-304 | SS7EI-3-316L |
| 4" | 4.468 | 4.750 | SS7EI-4-304 | SS7EI-4-316L |
| 6" | 6.750 | 6.565 | SS7EI-6-304 | SS7EI-6-316L |
| 8" | 8.125 | 7.940 | SS7EI-8-304 | SS7EI-8-316L |

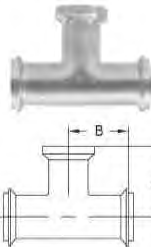

SS7HI--- TEE with Male I-Line Ferrules on All Ends, Polish ID/OD

| Tube OD (Size) | A | Part Number 304 | Part Number 316L |
|----------------|-------|-----------------|------------------|
| 1" | 1.688 | SS7HI-1-304 | SS7HI-1-316L |
| 1.5" | 2.406 | SS7HI-1.5-304 | SS7HI-1.5-316L |
| 2" | 2.812 | SS7HI-2-304 | SS7HI-2-316L |
| 2.5" | 3.156 | SS7HI-2.5-304 | SS7HI-2.5-316L |
| 3" | 3.500 | SS7HI-3-304 | SS7HI-3-316L |
| 4" | 4.468 | SS7HI-4-304 | SS7HI-4-316L |
| 6" | 6.565 | SS7HI-6-304 | SS7HI-6-316L |
| 8" | 7.940 | SS7HI-8-304 | SS7HI-8-316L |

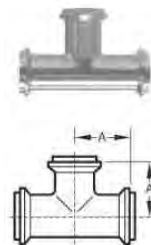

www.sanitarysolutionsinc.com



SANITARY SOLUTIONS INC.

Bulldog Fittings...Bulldog Tuff.

SS91--- CROSS--Female I-Line Ferrules (All ENDS) , Polish ID/OD

| Tube OD (Size) | A | | Part Number 304 | Part Number 316L |
|----------------|-------|--|-----------------|------------------|
| 1" | 2.660 | | SS91-1-304 | SS91-1-316L |
| 1.5" | 3.200 | | SS91-1.5-304 | SS91-1.5-316L |
| 2" | 4.040 | | SS91-2-304 | SS91-2-316L |
| 2.5" | 4.160 | | SS91-2.5-304 | SS91-2.5-316L |
| 3" | 4.470 | | SS91-3-304 | SS91-3-316L |
| 4" | 5.225 | | SS91-4-304 | SS91-4-316L |



SS131LC---Heavy Weight I-Line Clamp, 304

| Tube OD (Size) | A | SPR @ 70° F * | SPR @ 250° F * | Part Number 304 |
|----------------|-------|---------------|----------------|-------------------|
| 1"-- 1.5" | 2.122 | 700 | 250 | SS131LC-1-1.5-304 |
| 2" | 2.654 | 450 | 250 | SS131LC-2-304 |
| 2.5" | 3.185 | 450 | 200 | SS131LC-2.5-304 |
| 3" | 3.717 | 350 | 150 | SS131LC-3-304 |
| 4" | 4.820 | 200 | 125 | SS131LC-4-304 |
| 6" | 7.689 | 150 | 100 | SS131LC-6-304 |
| 8" | 9.689 | 125 | 75 | SS131LC-8-304 |

** Tighten Wing Nut to 25 in. lb. of torque*



SS131LB---Heavy Weight I-Line Bolted Clamp, 304

| Tube OD (Size) | A | SPR @ 70° F * | SPR @ 250° F * | Part Number 304 |
|----------------|-------|---------------|----------------|-------------------|
| 1"-- 1.5" | 2.122 | 1220 | 1100 | SS131LB-1-1.5-304 |
| 2" | 2.654 | 900 | 830 | SS131LB-2-304 |
| 2.5" | 3.185 | 720 | 660 | SS131LB-2.5-304 |
| 3" | 3.717 | 600 | 550 | SS131LB-3-304 |
| 4" | 4.820 | 570 | 525 | SS131LB-4-304 |

** Tighten Nut to 20 ft. lbs. of torque*



| Tube OD (Size) | A | SPR @ 70° F * | SPR @ 250° F * | Part Number 304 |
|----------------|-------|---------------|----------------|-----------------|
| 6" | 7.695 | 300 | 200 | SS131LB-6-304 |
| 8" | 9.695 | 250 | 150 | SS131LB-8-304 |

** Tighten Nut to 20 ft. lbs. of torque*





SANITARY SOLUTIONS INC.

Bulldog Fittings...Bulldog Tuff.

| SS14WI--- Male I-Line <i>Short</i> Weld Ferrule | | | | |
|---|-------|--|-----------------|------------------|
| Tube OD (Size) | A | | Part Number 304 | Part Number 316L |
| 1" | 0.590 | | SSI4WI-1-304 | SSI4WI-1-316L |
| 1.5" | 0.765 | | SSI4WI-1.5-304 | SSI4WI-1.5-316L |
| 2" | 0.790 | | SSI4WI-2-304 | SSI4WI-2-316L |
| 2.5" | 0.848 | | SSI4WI-2.5-304 | SSI4WI-2.5-316L |
| 3" | 0.906 | | SSI4WI-3-304 | SSI4WI-3-316L |
| 4" | 1.031 | | SSI4WI-4-304 | SSI4WI-4-316L |
| 6" | 0.937 | | SSI4WI-6-304 | SSI4WI-6-316L |
| 8" | 0.937 | | SSI4WI-8-304 | SSI4WI-8-316L |

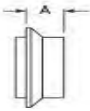

| SS14WLI--- Male I-Line <i>Long</i> Weld Ferrule | | | | |
|---|-------|--|-----------------|------------------|
| Tube OD (Size) | A | | Part Number 304 | Part Number 316L |
| 1" | 1.562 | | SSI4WLI-1-304 | SSI4WLI-1-316L |
| 1.5" | 1.843 | | SSI4WLI-1.5-304 | SSI4WLI-1.5-316L |
| 2" | 2.062 | | SSI4WLI-2-304 | SSI4WLI-2-316L |
| 2.5" | 2.188 | | SSI4WLI-2.5-304 | SSI4WLI-2.5-316L |
| 3" | 2.375 | | SSI4WLI-3-304 | SSI4WLI-3-316L |
| 4" | 2.687 | | SSI4WLI-4-304 | SSI4WLI-4-316L |
| 6" | 2.687 | | SSI4WLI-6-304 | SSI4WLI-6-316L |

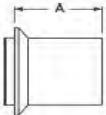

| SS14HRI--- Male I-Line Ferrule Rubber Hose Adapter | | | | |
|--|-------|--|-----------------|------------------|
| Tube OD (Size) | A | | Part Number 304 | Part Number 316L |
| 1" | 1.812 | | SSI4HRI-1-304 | SSI4HRI-1-316L |
| 1.5" | 1.937 | | SSI4HRI-1.5-304 | SSI4HRI-1.5-316L |
| 2" | 2.062 | | SSI4HRI-2-304 | SSI4HRI-2-316L |
| 2.5" | 2.437 | | SSI4HRI-2.5-304 | SSI4HRI-2.5-316L |
| 3" | 2.687 | | SSI4HRI-3-304 | SSI4HRI-3-316L |
| 4" | 3.687 | | SSI4HRI-4-304 | SSI4HRI-4-316L |

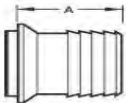

| SS14WHI--- Male I-Line Heavy Wall Tank Ferrule | | | | |
|--|-------|--|-----------------|------------------|
| Tube OD (Size) | A | | Part Number 304 | Part Number 316L |
| 1" | 1.312 | | SSI4WHI-1-304 | SSI4WHI-1-316L |
| 1.5" | 1.452 | | SSI4WHI-1.5-304 | SSI4WHI-1.5-316L |
| 2" | 1.500 | | SSI4WHI-2-304 | SSI4WHI-2-316L |
| 2.5" | 1.437 | | SSI4WHI-2.5-304 | SSI4WHI-2.5-316L |
| 3" | 1.500 | | SSI4WHI-3-304 | SSI4WHI-3-316L |
| 4" | 1.812 | | SSI4WHI-4-304 | SSI4WHI-4-316L |

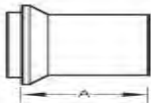



SANITARY SOLUTIONS INC.

Bulldog Fittings...Bulldog Tuff.



| SS15WI--- Female I-Line Short Weld Ferrule | | | | |
|--|-------|--|-----------------|------------------|
| Tube OD (Size) | A | | Part Number 304 | Part Number 316L |
| 1" | 0.784 | | SSI5WI-1-304 | SSI5WI-1-316L |
| 1.5" | 0.948 | | SSI5WI-1.5-304 | SSI5WI-1.5-316L |
| 2" | 1.036 | | SSI5WI-2-304 | SSI5WI-2-316L |
| 2.5" | 1.156 | | SSI5WI-2.5-304 | SSI5WI-2.5-316L |
| 3" | 1.218 | | SSI5WI-3-304 | SSI5WI-3-316L |
| 4" | 1.346 | | SSI5WI-4-304 | SSI5WI-4-316L |
| 6" | 1.125 | | SSI5WI-6-304 | SSI5WI-6-316L |
| 8" | 1.130 | | SSI5WI-8-304 | SSI5WI-8-316L |



| SS15WLI--- Female I-Line Long Weld Ferrule | | | | |
|--|-------|--|-----------------|------------------|
| Tube OD (Size) | A | | Part Number 304 | Part Number 316L |
| 1" | 1.750 | | SSI5WLI-1-304 | SSI5WLI-1-316L |
| 1.5" | 2.032 | | SSI5WLI-1.5-304 | SSI5WLI-1.5-316L |
| 2" | 2.312 | | SSI5WLI-2-304 | SSI5WLI-2-316L |
| 2.5" | 2.500 | | SSI5WLI-2.5-304 | SSI5WLI-2.5-316L |
| 3" | 2.687 | | SSI5WLI-3-304 | SSI5WLI-3-316L |
| 4" | 3.000 | | SSI5WLI-4-304 | SSI5WLI-4-316L |
| 6" | 3.000 | | SSI5WLI-6-304 | SSI5WLI-6-316L |

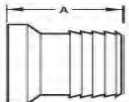

| SS15HRI--- Female I-Line Ferrule Rubber Hose Adapter | | | | |
|--|-------|--|------------------|------------------|
| Tube OD (Size) | A | | Part Number 304 | Part Number 316L |
| 1" | 4.062 | | SSI5HRI-1-304 | SSI5HRI-1-316L |
| 1.5" | 4.281 | | SSI5HRI-1.5-304 | SSI5HRI-1.5-316L |
| 2" | 4.062 | | SSI5HRI-2-304 | SSI5HRI-2-316L |
| 2.5" | 4.812 | | SSI15HRI-2.5-304 | SSI5HRI-2.5-316L |
| 3" | 5.062 | | SSI5HRI-3-304 | SSI5HRI-3-316L |
| 4" | 4.188 | | SSI5HRI-4-304 | SSI5HRI-4-316L |

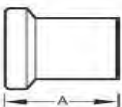

| SS15WHI--- Female I-Line Heavy Wall Tank Ferrule | | | | |
|--|-------|--|-----------------|------------------|
| Tube OD (Size) | A | | Part Number 304 | Part Number 316L |
| 1" | 1.500 | | SSI5WHI-1-304 | SSI5WHI-1-316L |
| 1.5" | 1.625 | | SSI5WHI-1.5-304 | SSI5WHI-1.5-316L |
| 2" | 1.750 | | SSI5WHI-2-304 | SSI5WHI-2-316L |
| 2.5" | 1.750 | | SSI5WHI-2.5-304 | SSI5WHI-2.5-316L |
| 3" | 1.812 | | SSI5WHI-3-304 | SSI5WHI-3-316L |
| 4" | 2.125 | | SSI5WHI-4-304 | SSI5WHI-4-316L |



SANITARY SOLUTIONS INC.

Bulldog Fittings...Bulldog Tuff.

SS16AI-14I---Male I-Line Solid End Cap

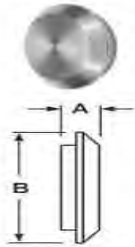

| Tube OD (Size) | A | B | Part Number | |
|-------------------|-------|-------|--------------------|---------------------|
| | | | 304 | 316L |
| 1" | 0.500 | 1.985 | SS16AI-14I-1-304 | SS16AI-14I-1-316L |
| 1.5" | 0.500 | 1.985 | SS16AI-14I-1.5-304 | SS16AI-14I-1.5-316L |
| 2" | 0.687 | 2.640 | SS16AI-14I-2-304 | SS16AI-14I-2-316L |
| 2.5" | 0.687 | 3.307 | SS16AI-14I-2.5-304 | SS16AI-14I-2.5-316L |
| 3" | 0.687 | 3.870 | SS16AI-14I-3-304 | SS16AI-14I-3-316L |
| 4" | 0.750 | 4.870 | SS16AI-14I-4-304 | SS16AI-14I-4-316L |
| 6" | 0.750 | 7.495 | SS16AI-14I-6-304 | SS16AI-14I-6-316L |
| 8" | 0.880 | 9.495 | SS16AI-14I-8-304 | SS16AI-14I-8-316L |

SS16AI-15I---Female I-Line Solid End Cap

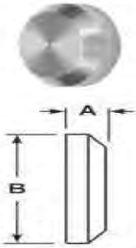

| Tube OD (Size) | A | B | Part Number | |
|-------------------|-------|-------|--------------------|---------------------|
| | | | 304 | 316L |
| 1" | 0.500 | 1.985 | SS16AI-15I-1-304 | SS16AI-15I-1-316L |
| 1.5" | 0.500 | 1.985 | SS16AI-15I-1.5-304 | SS16AI-15I-1.5-316L |
| 2" | 0.687 | 2.640 | SS16AI-15I-2-304 | SS16AI-15I-2-316L |
| 2.5" | 0.687 | 3.307 | SS16AI-15I-2.5-304 | SS16AI-15I-2.5-316L |
| 3" | 0.687 | 3.870 | SS16AI-15I-3-304 | SS16AI-15I-3-316L |
| 4" | 0.750 | 4.870 | SS16AI-15I-4-304 | SS16AI-15I-4-316L |
| 6" | 0.750 | 7.495 | SS16AI-15I-6-304 | SS16AI-15I-6-316L |
| 8" | 0.880 | 9.495 | SS16AI-15I-8-304 | SS16AI-15I-8-316L |

SS17I-14I-14I---Male I-Line Ferrule x Male I-Line Ferrule Adapter

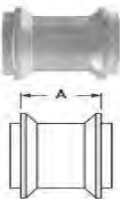

| Tube OD (Size) | A | Part Number | |
|-------------------|-------|-----------------------|------------------------|
| | | 304 | 316L |
| 1" | 1.200 | SS17I-14I-14I-1-304 | SS17I-14I-14I-1-316L |
| 1.5" | 1.530 | SS17I-14I-14I-1.5-304 | SS17I-14I-14I-1.5-316L |
| 2" | 1.580 | SS17I-14I-14I-2-304 | SS17I-14I-14I-2-316L |
| 2.5" | 1.696 | SS17I-14I-14I-2.5-304 | SS17I-14I-14I-2.5-316L |
| 3" | 1.812 | SS17I-14I-14I-3-304 | SS17I-14I-14I-3-316L |
| 4" | 2.062 | SS17I-14I-14I-4-304 | SS17I-14I-14I-4-316L |

SS17I-14I-14MP---Male I-Line Ferrule x Clamp Adapter



| Tube OD (Size) | A | Part Number | |
|-------------------|-------|------------------------|-------------------------|
| | | 304 | 316L |
| 1" | 1.093 | SS17I-14I-14MP-1-304 | SS17I-14I-14MP-1-316L |
| 1.5" | 1.250 | SS17I-14I-14MP-1.5-304 | SS17I-14I-14MP-1.5-316L |
| 2" | 1.250 | SS17I-14I-14MP-2-304 | SS17I-14I-14MP-2-316L |
| 2.5" | 1.312 | SS17I-14I-14MP-2.5-304 | SS17I-14I-14MP-2.5-316L |
| 3" | 1.406 | SS17I-14I-14MP-3-304 | SS17I-14I-14MP-3-316L |
| 4" | 1.656 | SS17I-14I-14MP-4-304 | SS17I-14I-14MP-4-316L |

www.sanitarysolutionsinc.com



SANITARY SOLUTIONS INC.

Bulldog Fittings...Bulldog Tuff.

SS171-14I-15I-Male I-Line Ferrule x Female I-Line Ferrule Adapter

| Tube OD (Size) | A | Part Number 304 | Part Number 316L |
|----------------|-------|-----------------------|------------------------|
| 1" | 1.318 | SS171-14I-15I-1-304 | SS171-14I-15I-1-316L |
| 1.5" | 1.468 | SS171-14I-15I-1.5-304 | SS171-14I-15I-1.5-316L |
| 2" | 1.500 | SS171-14I-15I-2-304 | SS171-14I-15I-2-316L |
| 2.5" | 1.688 | SS171-14I-15I-2.5-304 | SS171-14I-15I-2.5-316L |
| 3" | 1.812 | SS171-14I-15I-3-304 | SS171-14I-15I-3-316L |
| 4" | 2.062 | SS171-14I-15I-4-304 | SS171-14I-15I-4-316L |



SS171-15I-14MP-Female I-Line Ferrule x Clamp Adapter

| Tube OD (Size) | A | Part Number 304 | Part Number 316L |
|----------------|-------|------------------------|-------------------------|
| 1" | 1.281 | SS171-15I-14MP-1-304 | SS171-15I-14MP-1-316L |
| 1.5" | 1.437 | SS171-15I-14MP-1.5-304 | SS171-15I-14MP-1.5-316L |
| 2" | 1.540 | SS171-15I-14MP-2-304 | SS171-15I-14MP-2-316L |
| 2.5" | 1.625 | SS171-15I-14MP-2.5-304 | SS171-15I-14MP-2.5-316L |
| 3" | 1.718 | SS171-15I-14MP-3-304 | SS171-15I-14MP-3-316L |
| 4" | 1.968 | SS171-15I-14MP-4-304 | SS171-15I-14MP-4-316L |



SS171-15I-15I- Female I-Line Ferrule x Female I-Line Ferrule Adapter

| Tube OD (Size) | A | Part Number 304 | Part Number 316L |
|----------------|-------|-----------------------|------------------------|
| 1" | 1.562 | SS171-15I-15I-1-304 | SS171-15I-15I-1-316L |
| 1.5" | 1.875 | SS171-15I-15I-1.5-304 | SS171-15I-15I-1.5-316L |
| 2" | 2.062 | SS171-15I-15I-2-304 | SS171-15I-15I-2-316L |
| 2.5" | 2.312 | SS171-15I-15I-2.5-304 | SS171-15I-15I-2.5-316L |
| 3" | 2.437 | SS171-15I-15I-3-304 | SS171-15I-15I-3-316L |
| 4" | 2.688 | SS171-15I-15I-4-304 | SS171-15I-15I-4-316L |



SS211-14I-Male I-Line Ferrule x (MNPT) Adapter

| Tube OD (Size) | A | Part Number 304 | Part Number 316L |
|----------------|-------|-------------------|--------------------|
| 1" x 1" | 2.343 | SS211-14I-1-304 | SS211-14I-1-316L |
| 1.5" x 1.5" | 2.500 | SS211-14I-1.5-304 | SS211-14I-1.5-316L |
| 2" x 2" | 2.593 | SS211-14I-2-304 | SS211-14I-2-316L |
| 2.5" x 2.5" | 3.125 | SS211-14I-2.5-304 | SS211-14I-2.5-316L |
| 3" x 3" | 3.406 | SS211-14I-3-304 | SS211-14I-3-316L |
| 4" x 4" | 3.593 | SS211-14I-4-304 | SS211-14I-4-316L |

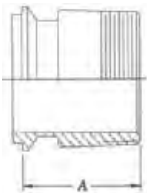



SANITARY SOLUTIONS INC.

Bulldog Fittings...Bulldog Tuff.

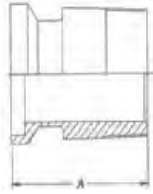

| SS211-15I- Female I-Line Ferrule x (MNPT) Adapter | | | | | |
|---|-------|--|-------------------|--------------------|--|
| Tube OD (Size) | A | | Part Number 304 | Part Number 316L | |
| 1" x 1" | 2.531 | | SS211-15I-1-304 | SS211-15I-1-316L | |
| 1.5" x 1.5" | 2.688 | | SS211-15I-1.5-304 | SS211-15I-1.5-316L | |
| 2" x 2" | 2.844 | | SS211-15I-2-304 | SS211-15I-2-316L | |
| 2.5" x 2.5" | 3.438 | | SS211-15I-2.5-304 | SS211-15I-2.5-316L | |
| 3" x 3" | 3.719 | | SS211-15I-3-304 | SS211-15I-3-316L | |
| 4" x 4" | 3.906 | | SS211-15I-4-304 | SS211-15I-4-316L | |

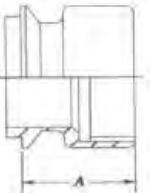

| SS221-14I- Male I-Line Ferrule x (FNPT) Adapter | | | | | |
|---|-------|--|-------------------|--------------------|--|
| Tube OD (Size) | A | | Part Number 304 | Part Number 316L | |
| 1" x 1" | 1.688 | | SS221-14I-1-304 | SS221-14I-1-316L | |
| 1.5" x 1.5" | 2.188 | | SS221-14I-1.5-304 | SS221-14I-1.5-316L | |
| 2" x 2" | 2.219 | | SS221-14I-2-304 | SS221-14I-2-316L | |
| 2.5" x 2.5" | 2.438 | | SS221-14I-2.5-304 | SS221-14I-2.5-316L | |
| 3" x 3" | 2.719 | | SS221-14I-3-304 | SS221-14I-3-316L | |
| 4" x 4" | 3.031 | | SS221-14I-4-304 | SS221-14I-4-316L | |

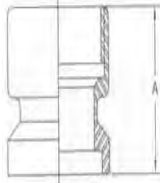

| SS221-15I- Female I-Line Ferrule x (FNPT) Adapter | | | | | |
|---|-------|--|-------------------|--------------------|--|
| Tube OD (Size) | A | | Part Number 304 | Part Number 316L | |
| 1" x 1" | 1.906 | | SS221-15I-1-304 | SS221-15I-1-316L | |
| 1.5" x 1.5" | 2.375 | | SS221-15I-1.5-304 | SS221-15I-1.5-316L | |
| 2" x 2" | 2.469 | | SS221-15I-2-304 | SS221-15I-2-316L | |
| 2.5" x 2.5" | 2.781 | | SS221-15I-2.5-304 | SS221-15I-2.5-316L | |
| 3" x 3" | 3.031 | | SS221-15I-3-304 | SS221-15I-3-316L | |
| 4" x 4" | 3.343 | | SS221-15I-4-304 | SS221-15I-4-316L | |

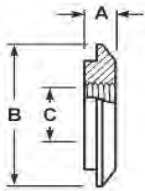

| SS23BI--- I-Line Thermometer Cap | | | | | | |
|----------------------------------|-------|-------|----------|--|-----------------|------------------|
| Tube OD (Size) | A | B | C | | Part Number 304 | Part Number 316L |
| 1" | 1.985 | 0.500 | 1/2" NPT | | SS23BI-1-304 | SS23BI-1-316L |
| 1.5" | 1.985 | 0.500 | 3/4" NPT | | SS23BI-1.5-304 | SS23BI-1.5-316L |
| 2" | 2.640 | 0.563 | 3/4" NPT | | SS23BI-2-304 | SS23BI-2-316L |
| 2.5" | 3.307 | 0.750 | 3/4" NPT | | SS23BI-2.5-304 | SS23BI-2.5-316L |
| 3" | 3.870 | 0.750 | 3/4" NPT | | SS23BI-3-304 | SS23BI-3-316L |
| 4" | 4.870 | 0.750 | 3/4" NPT | | SS23BI-4-304 | SS23BI-4-316L |

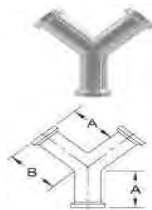

| SS28YI-15I- Female I-Line Ferrules (All Ends) True "Y" | | | | | |
|--|-------|-------|--|--------------------|---------------------|
| Tube OD (Size) | A | B | | Part Number 304 | Part Number 316L |
| 1" | 2.785 | 3.223 | | SS28YI-15I-1-304 | SS28YI-15I-1-316L |
| 1.5" | 2.950 | 3.388 | | SS28YI-15I-1.5-304 | SS28YI-15I-1.5-316L |
| 2" | 3.665 | 4.290 | | SS28YI-15I-2-304 | SS28YI-15I-2-316L |
| 2.5" | 4.530 | 5.285 | | SS28YI-15I-2.5-304 | SS28YI-15I-2.5-316L |
| 3" | 5.220 | 6.095 | | SS28YI-15I-3-304 | SS28YI-15I-3-316L |
| 4" | 6.725 | 6.725 | | SS28YI-15I-4-304 | SS28YI-15I-4-316L |

Note: Female I-Line Lateral Available (1"--4")

www.sanitarysolutionsinc.com

Sanitary Solutions Inc.

62

1 - 888 - 909 - 3569

Prices are subject to change without notice; please call before you quote



SANITARY SOLUTIONS INC.

Bulldog Fittings...Bulldog Tuff.

3114I-14I--- Male I-Line Ferrule on Each End Concentric Reducer, Polish ID/OD

| Tube OD (Size) | A | Part Number 304 | Part Number 316L |
|----------------|-------|---------------------------|----------------------------|
| 1.5" x 1" | 3.365 | 3114I-14I- 1.5 x 1- 304 | 3114I-14I- 1.5 x 1- 316L |
| 2" x 1" | 5.390 | 3114I-14I- 2 x 1- 304 | 3114I-14I- 2 x 1- 316L |
| 2" x 1.5" | 3.555 | 3114I-14I- 2 x 1.5-304 | 3114I-14I- 2 x 1.5-316L |
| 2.5" x 1.5" | 5.613 | 3114I-14I- 2.5 x 1.5- 304 | 3114I-14I- 2.5 x 1.5- 316L |
| 2.5" x 2" | 3.638 | 3114I-14I- 2.5 x 2- 304 | 3114I-14I- 2.5 x 2- 316L |
| 3" x 1.5" | 7.665 | 3114I-14I- 3 x 1.5-304 | 3114I-14I- 3 x 1.5-316L |
| 3" x 2" | 5.690 | 3114I-14I- 3 x 2-304 | 3114I-14I- 3 x 2-316L |
| 3" x 2.5" | 3.745 | 3114I-14I- 3 x 2.5-304 | 3114I-14I- 3 x 2.5-316L |
| 4" x 2" | 9.828 | 3114I-14I- 4 x 2-304 | 3114I-14I- 4 x 2-316L |
| 4" x 2.5" | 7.886 | 3114I-14I- 4 x 2.5-304 | 3114I-14I- 4 x 2.5-316L |
| 4" x 3" | 5.938 | 3114I-14I- 4 x 3- 304 | 3114I-14I- 4 x 3- 316L |
| 6" x 3" | 7.348 | 3114I-14I- 6 x 3-304 | 3114I-14I- 6 x 3-316L |
| 6" x 4" | 7.478 | 3114I-14I- 6 x 4-304 | 3114I-14I- 6 x 4-316L |

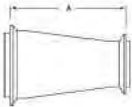

3114I-15I--- Male I-Line Ferrule (Large End)x Female I-Line Ferrule Concentric Reducer, Polish ID/OD

| Tube OD (Size) | A | Part Number 304 | Part Number 316L |
|----------------|-------|---------------------------|----------------------------|
| 1.5" x 1" | 3.550 | 3114I-15I- 1.5 x 1- 304 | 3114I-15I- 1.5 x 1- 316L |
| 2" x 1" | 5.640 | 3114I-15I- 2 x 1- 304 | 3114I-15I- 2 x 1- 316L |
| 2" x 1.5" | 3.805 | 3114I-15I- 2 x 1.5-304 | 3114I-15I- 2 x 1.5-316L |
| 2.5" x 1.5" | 5.925 | 3114I-15I- 2.5 x 1.5- 304 | 3114I-15I- 2.5 x 1.5- 316L |
| 2.5" x 2" | 3.950 | 3114I-15I- 2.5 x 2- 304 | 3114I-15I- 2.5 x 2- 316L |
| 3" x 1.5" | 7.985 | 3114I-15I- 3 x 1.5-304 | 3114I-15I- 3 x 1.5-316L |
| 3" x 2" | 6.010 | 3114I-15I- 3 x 2-304 | 3114I-15I- 3 x 2-316L |
| 3" x 2.5" | 4.068 | 3114I-15I- 3 x 2.5-304 | 3114I-15I- 3 x 2.5-316L |
| 4" x 2" | 10.14 | 3114I-15I- 4 x 2-304 | 3114I-15I- 4 x 2-316L |
| 4" x 2.5" | 8.198 | 3114I-15I- 4 x 2.5-304 | 3114I-15I- 4 x 2.5-316L |
| 4" x 3" | 6.250 | 3114I-15I- 4 x 3- 304 | 3114I-15I- 4 x 3- 316L |
| 6" x 3" | 7.535 | 3114I-15I- 6 x 3-304 | 3114I-15I- 6 x 3-316L |
| 6" x 4" | 4.663 | 3114I-15I- 6 x 4-304 | 3114I-15I- 6 x 4-316L |

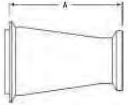

3115I-14I--- Female I-Line Ferrule (Large End) x Male I-Line Ferrule Concentric Reducer, Polish ID/OD

| Tube OD (Size) | A | Part Number 304 | Part Number 316L |
|----------------|-------|---------------------------|----------------------------|
| 1.5" x 1" | 3.550 | 3115I-14I- 1.5 x 1- 304 | 3115I-14I- 1.5 x 1- 316L |
| 2" x 1" | 5.640 | 3115I-14I- 2 x 1- 304 | 3115I-14I- 2 x 1- 316L |
| 2" x 1.5" | 3.805 | 3115I-14I- 2 x 1.5-304 | 3115I-14I- 2 x 1.5-316L |
| 2.5" x 1.5" | 5.925 | 3115I-14I- 2.5 x 1.5- 304 | 3115I-14I- 2.5 x 1.5- 316L |
| 2.5" x 2" | 3.950 | 3115I-14I- 2.5 x 2- 304 | 3115I-14I- 2.5 x 2- 316L |
| 3" x 1.5" | 7.985 | 3115I-14I- 3 x 1.5-304 | 3115I-14I- 3 x 1.5-316L |
| 3" x 2" | 6.010 | 3115I-14I- 3 x 2-304 | 3115I-14I- 3 x 2-316L |
| 3" x 2.5" | 4.068 | 3115I-14I- 3 x 2.5-304 | 3115I-14I- 3 x 2.5-316L |
| 4" x 2" | 10.14 | 3115I-14I- 4 x 2-304 | 3115I-14I- 4 x 2-316L |
| 4" x 2.5" | 8.198 | 3115I-14I- 4 x 2.5-304 | 3115I-14I- 4 x 2.5-316L |
| 4" x 3" | 6.250 | 3115I-14I- 4 x 3- 304 | 3115I-14I- 4 x 3- 316L |
| 6" x 3" | 7.535 | 3115I-14I- 6 x 3-304 | 3115I-14I- 6 x 3-316L |
| 6" x 4" | 4.663 | 3115I-14I- 6 x 4-304 | 3115I-14I- 6 x 4-316L |

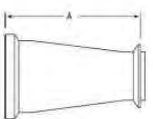

www.sanitarysolutionsinc.com



SANITARY SOLUTIONS INC.

Bulldog Fittings...Bulldog Tuff.

3115I-15I--- Female I-Line Ferrule x Female I-Line Ferrule Concentric Reducer, Polish ID/OD

| Tube OD (Size) | A | Part Number 304 | Part Number 316L |
|----------------|-------|---------------------------|----------------------------|
| 1.5" x 1" | 3.735 | 3115I-15I- 1.5 x 1- 304 | 3115I-15I- 1.5 x 1- 316L |
| 2" x 1" | 5.825 | 3115I-15I- 2 x 1- 304 | 3115I-15I- 2 x 1- 316L |
| 2" x 1.5" | 3.990 | 3115I-15I- 2 x 1.5-304 | 3115I-15I- 2 x 1.5-316L |
| 2.5" x 1.5" | 6.110 | 3115I-15I- 2.5 x 1.5- 304 | 3115I-15I- 2.5 x 1.5- 316L |
| 2.5" x 2" | 4.200 | 3115I-15I- 2.5 x 2- 304 | 3115I-15I- 2.5 x 2- 316L |
| 3" x 1.5" | 8.170 | 3115I-15I- 3 x 1.5-304 | 3115I-15I- 3 x 1.5-316L |
| 3" x 2" | 6.260 | 3115I-15I- 3 x 2-304 | 3115I-15I- 3 x 2-316L |
| 3" x 2.5" | 4.380 | 3115I-15I- 3 x 2.5-304 | 3115I-15I- 3 x 2.5-316L |
| 4" x 2" | 10.39 | 3115I-15I- 4 x 2-304 | 3115I-15I- 4 x 2-316L |
| 4" x 2.5" | 8.510 | 3115I-15I- 4 x 2.5-304 | 3115I-15I- 4 x 2.5-316L |
| 4" x 3" | 6.570 | 3115I-15I- 4 x 3- 304 | 3115I-15I- 4 x 3- 316L |
| 6" x 3" | 7.845 | 3115I-15I- 6 x 3-304 | 3115I-15I- 6 x 3-316L |
| 6" x 4" | 7.975 | 3115I-15I- 6 x 4-304 | 3115I-15I- 6 x 4-316L |



3214I-14I--- Male I-Line Ferrule x Male I-Line Ferrule Eccentric Reducer, Polish ID/OD

| Tube OD (Size) | A | Part Number 304 | Part Number 316L |
|----------------|-------|---------------------------|----------------------------|
| 1.5" x 1" | 3.365 | 3214I-14I- 1.5 x 1- 304 | 3214I-14I- 1.5 x 1- 316L |
| 2" x 1" | 5.390 | 3214I-14I- 2 x 1- 304 | 3214I-14I- 2 x 1- 316L |
| 2" x 1.5" | 3.555 | 3214I-14I- 2 x 1.5-304 | 3214I-14I- 2 x 1.5-316L |
| 2.5" x 1.5" | 5.613 | 3214I-14I- 2.5 x 1.5- 304 | 3214I-14I- 2.5 x 1.5- 316L |
| 2.5" x 2" | 3.638 | 3214I-14I- 2.5 x 2- 304 | 3214I-14I- 2.5 x 2- 316L |
| 3" x 1.5" | 7.665 | 3214I-14I- 3 x 1.5-304 | 3214I-14I- 3 x 1.5-316L |
| 3" x 2" | 5.690 | 3214I-14I- 3 x 2-304 | 3214I-14I- 3 x 2-316L |
| 3" x 2.5" | 3.745 | 3214I-14I- 3 x 2.5-304 | 3214I-14I- 3 x 2.5-316L |
| 4" x 2" | 9.828 | 3214I-14I- 4 x 2-304 | 3214I-14I- 4 x 2-316L |
| 4" x 2.5" | 7.886 | 3214I-14I- 4 x 2.5-304 | 3214I-14I- 4 x 2.5-316L |
| 4" x 3" | 5.938 | 3214I-14I- 4 x 3- 304 | 3214I-14I- 4 x 3- 316L |
| 6" x 3" | 7.348 | 3214I-14I- 6 x 3-304 | 3214I-14I- 6 x 3-316L |
| 6" x 4" | 7.478 | 3214I-14I- 6 x 4-304 | 3214I-14I- 6 x 4-316L |

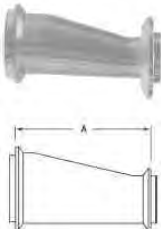

3214I-15I--- Male I-Line Ferrule x Female I-Line Ferrule Eccentric Reducer, Polish ID/OD

| Tube OD (Size) | A | Part Number 304 | Part Number 316L |
|----------------|-------|---------------------------|----------------------------|
| 1.5" x 1" | 3.550 | 3214I-15I- 1.5 x 1- 304 | 3214I-15I- 1.5 x 1- 316L |
| 2" x 1" | 5.575 | 3214I-15I- 2 x 1- 304 | 3214I-15I- 2 x 1- 316L |
| 2" x 1.5" | 3.740 | 3214I-15I- 2 x 1.5-304 | 3214I-15I- 2 x 1.5-316L |
| 2.5" x 1.5" | 5.798 | 3214I-15I- 2.5 x 1.5- 304 | 3214I-15I- 2.5 x 1.5- 316L |
| 2.5" x 2" | 3.888 | 3214I-15I- 2.5 x 2- 304 | 3214I-15I- 2.5 x 2- 316L |
| 3" x 1.5" | 7.858 | 3214I-15I- 3 x 1.5-304 | 3214I-15I- 3 x 1.5-316L |
| 3" x 2" | 5.948 | 3214I-15I- 3 x 2-304 | 3214I-15I- 3 x 2-316L |
| 3" x 2.5" | 6.068 | 3214I-15I- 3 x 2.5-304 | 3214I-15I- 3 x 2.5-316L |
| 4" x 2" | 10.08 | 3214I-15I- 4 x 2-304 | 3214I-15I- 4 x 2-316L |
| 4" x 2.5" | 8.198 | 3214I-15I- 4 x 2.5-304 | 3214I-15I- 4 x 2.5-316L |
| 4" x 3" | 6.250 | 3214I-15I- 4 x 3- 304 | 3214I-15I- 4 x 3- 316L |
| 6" x 3" | 7.660 | 3214I-15I- 6 x 3-304 | 3214I-15I- 6 x 3-316L |
| 6" x 4" | 7.790 | 3214I-15I- 6 x 4-304 | 3214I-15I- 6 x 4-316L |



www.sanitarysolutionsinc.com



SANITARY SOLUTIONS INC.

Bulldog Fittings...Bulldog Tuff.

3215I-14I--- Female I-Line x Male I-Line Eccentric Reducer, Polish ID/OD

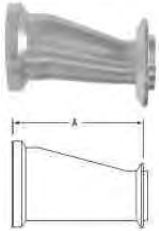

| Tube OD (Size) | A | | Part Number 304 | Part Number 316L |
|----------------|-------|--|---------------------------|----------------------------|
| 1.5" x 1" | 3.550 | | 3215I-14I- 1.5 x 1- 304 | 3215I-14I- 1.5 x 1- 316L |
| 2" x 1" | 5.640 | | 3215I-14I- 2 x 1- 304 | 3215I-14I- 2 x 1- 316L |
| 2" x 1.5" | 3.805 | | 3215I-14I- 2 x 1.5-304 | 3215I-14I- 2 x 1.5-316L |
| 2.5" x 1.5" | 5.925 | | 3215I-14I- 2.5 x 1.5- 304 | 3215I-14I- 2.5 x 1.5- 316L |
| 2.5" x 2" | 3.950 | | 3215I-14I- 2.5 x 2- 304 | 3215I-14I- 2.5 x 2- 316L |
| 3" x 1.5" | 7.985 | | 3215I-14I- 3 x 1.5-304 | 3215I-14I- 3 x 1.5-316L |
| 3" x 2" | 6.010 | | 3215I-14I- 3 x 2-304 | 3215I-14I- 3 x 2-316L |
| 3" x 2.5" | 4.068 | | 3215I-14I- 3 x 2.5-304 | 3215I-14I- 3 x 2.5-316L |
| 4" x 2" | 10.14 | | 3215I-14I- 4 x 2-304 | 3215I-14I- 4 x 2-316L |
| 4" x 2.5" | 8.198 | | 3215I-14I- 4 x 2.5-304 | 3215I-14I- 4 x 2.5-316L |
| 4" x 3" | 6.250 | | 3215I-14I- 4 x 3- 304 | 3215I-14I- 4 x 3- 316L |
| 6" x 3" | 7.535 | | 3215I-14I- 6 x 3-304 | 3215I-14I- 6 x 3-316L |
| 6" x 4" | 7.656 | | 3215I-14I- 6 x 4-304 | 3215I-14I- 6 x 4-316L |

3215I-15I--- Female I-Line Ferrule (Each End) Eccentric Reducer, Polish ID/OD

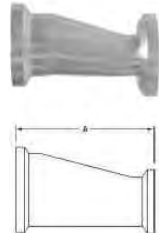

| Tube OD (Size) | A | | Part Number 304 | Part Number 316L |
|----------------|-------|--|---------------------------|----------------------------|
| 1.5" x 1" | 3.550 | | 3215I-15I- 1.5 x 1- 304 | 3215I-15I- 1.5 x 1- 316L |
| 2" x 1" | 5.640 | | 3215I-15I- 2 x 1- 304 | 3215I-15I- 2 x 1- 316L |
| 2" x 1.5" | 3.805 | | 3215I-15I- 2 x 1.5-304 | 3215I-15I- 2 x 1.5-316L |
| 2.5" x 1.5" | 5.925 | | 3215I-15I- 2.5 x 1.5- 304 | 3215I-15I- 2.5 x 1.5- 316L |
| 2.5" x 2" | 3.950 | | 3215I-15I- 2.5 x 2- 304 | 3215I-15I- 2.5 x 2- 316L |
| 3" x 1.5" | 7.985 | | 3215I-15I- 3 x 1.5-304 | 3215I-15I- 3 x 1.5-316L |
| 3" x 2" | 6.010 | | 3215I-15I- 3 x 2-304 | 3215I-15I- 3 x 2-316L |
| 3" x 2.5" | 4.068 | | 3215I-15I- 3 x 2.5-304 | 3215I-15I- 3 x 2.5-316L |
| 4" x 2" | 10.14 | | 3215I-15I- 4 x 2-304 | 3215I-15I- 4 x 2-316L |
| 4" x 2.5" | 8.198 | | 3215I-15I- 4 x 2.5-304 | 3215I-15I- 4 x 2.5-316L |
| 4" x 3" | 6.250 | | 3215I-15I- 4 x 3- 304 | 3215I-15I- 4 x 3- 316L |
| 6" x 3" | 7.533 | | 3215I-15I- 6 x 3-304 | 3215I-15I- 6 x 3-316L |
| 6" x 4" | 7.663 | | 3215I-15I- 6 x 4-304 | 3215I-15I- 6 x 4-316L |

SS14WIV--- Schedule 5 Short-Weld Male I-Line Ferrule

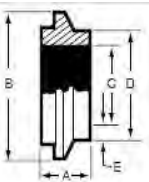

| Tube OD (Size) | A | B | C | D | Part Number 304 | Part Number 316L |
|----------------|-------|-------|-------|-------|-----------------|------------------|
| 1" | 0.945 | 2.000 | 1.185 | 1.315 | SS14WIV-1-304 | SS14WIV-1-316L |
| 1.5" | 1.024 | 2.648 | 1.770 | 1.900 | SS14WIV-1.5-304 | SS14WIV-1.5-316L |
| 2" | 1.142 | 3.317 | 2.245 | 2.375 | SS14WIV-2-304 | SS14WIV-2-316L |
| 2.5" | 1.220 | 3.868 | 2.709 | 2.875 | SS14WIV-2.5-304 | SS14WIV-2.5-316L |
| 3" | 1.343 | 4.882 | 3.334 | 3.500 | SS14WIV-3-304 | SS14WIV-3-316L |
| 4" | 1.343 | 5.882 | 4.334 | 4.500 | SS14WIV-4-304 | SS14WIV-4-316L |

www.sanitarysolutionsinc.com

Sanitary Solutions Inc.

65

1 - 888 - 909 - 3569

Prices are subject to change without notice; please call before you quote



SANITARY SOLUTIONS INC.

Bulldog Fittings...Bulldog Tuff.

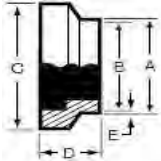

| SS15WIV--- Schedule 5 Pipe Short-Weld Female I-Line Ferrule | | | | | | |
|---|-------|-------|-------|-------|-----------------|------------------|
| Tube OD (Size) | A | B | C | D | Part Number 304 | Part Number 316L |
| 1" | 0.945 | 1.185 | 2.000 | 0.945 | SS15WIV-1-304 | SS15WIV-1-316L |
| 1.5" | 1.024 | 1.770 | 2.648 | 1.024 | SS15WIV-1.5-304 | SS15WIV-1.5-316L |
| 2" | 1.142 | 2.245 | 3.317 | 1.142 | SS15WIV-2-304 | SS15WIV-2-316L |
| 2.5" | 1.220 | 2.709 | 3.868 | 1.220 | SS15WIV-2.5-304 | SS15WIV-2.5-316L |
| 3" | 1.343 | 3.334 | 4.882 | 1.343 | SS15WIV-3-304 | SS15WIV-3-316L |
| 4" | 1.343 | 4.334 | 5.882 | 1.343 | SS15WIV-4-304 | SS15WIV-4-316L |

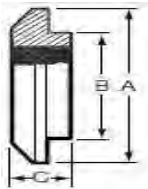

| SS16AI-14IV-- Schedule 5 Male I-Line End Cap | | | | | |
|--|-------|-------|-------|---------------------|----------------------|
| Tube OD (Size) | A | B | C | Part Number 304 | Part Number 316L |
| 1" | 2.000 | 1.756 | 0.500 | SS16AI-14IV-1-304 | SS16AI-14IV-1-316L |
| 1.5" | 2.648 | 2.244 | 0.585 | SS16AI-14IV-1.5-304 | SS16AI-14IV-1.5-316L |
| 2" | 3.317 | 2.756 | 0.750 | SS16AI-14IV-2-304 | SS16AI-14IV-2-316L |
| 2.5" | 3.868 | 3.316 | 0.750 | SS16AI-14IV-2.5-304 | SS16AI-14IV-2.5-316L |
| 3" | 4.882 | 4.316 | 0.750 | SS16AI-14IV-3-304 | SS16AI-14IV-3-316L |
| 4" | 5.582 | 5.316 | 0.750 | SS16AI-14IV-4-304 | SS16AI-14IV-4-316L |

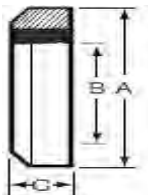

| SS16AI-15IV-- Schedule 5 Female I-Line End Cap | | | | | |
|--|-------|-------|-------|---------------------|----------------------|
| Tube OD (Size) | A | B | C | Part Number 304 | Part Number 316L |
| 1" | 2.000 | 1.756 | 0.500 | SS16AI-15IV-1-304 | SS16AI-15IV-1-316L |
| 1.5" | 2.648 | 2.244 | 0.585 | SS16AI-15IV-1.5-304 | SS16AI-15IV-1.5-316L |
| 2" | 3.317 | 2.756 | 0.750 | SS16AI-15IV-2-304 | SS16AI-15IV-2-316L |
| 2.5" | 3.868 | 3.316 | 0.750 | SS16AI-15IV-2.5-304 | SS16AI-15IV-2.5-316L |
| 3" | 4.882 | 4.316 | 0.750 | SS16AI-15IV-3-304 | SS16AI-15IV-3-316L |
| 4" | 5.582 | 5.316 | 0.750 | SS16AI-15IV-4-304 | SS16AI-15IV-4-316L |